

WANAKA LAKEFRONT DEVELOPMENT PROJECT - STAGE 5

WANAKA MARINA AND YACHT CLUB

DRAWINGS INDEX

DWG No.	DRAWING TITLE
310103860-05-001-C000	COVER SHEET, DRAWING INDEX & LOCATION PLAN
310103860-05-001-C001	GENERAL LAYOUT PLAN
310103860-05-001-C002	GENERAL NOTES
310103860-05-001-C101	SEGMENT 1 LAYOUT PLAN
310103860-05-001-C102	SEGMENT 2 LAYOUT PLAN SHEET 1
310103860-05-001-C103	SEGMENT 2 LAYOUT PLAN SHEET 2
310103860-05-001-C104	SEGMENT 2 LAYOUT PLAN SHEET 3
310103860-05-001-C105	SEGMENT 3 LAYOUT PLAN SHEET 1
310103860-05-001-C106	SEGMENT 3 LAYOUT PLAN SHEET 2
310103860-05-001-C201	RETAINING WALL AND PATH LONGITUDINAL SECTION
310103860-05-001-C301	PATH CROSS-SECTIONS SHEET 1 OF 4
310103860-05-001-C302	PATH CROSS-SECTIONS SHEET 2 OF 4
310103860-05-001-C303	PATH CROSS-SECTIONS SHEET 3 OF 4
310103860-05-001-C304	PATH CROSS-SECTIONS SHEET 4 OF 4
310103860-05-001-C801	TYPICAL DETAILS SHEET 1 OF 4
310103860-05-001-C802	TYPICAL DETAILS SHEET 2 OF 4
310103860-05-001-C803	TYPICAL DETAILS SHEET 3 OF 4
310103860-05-001-C804	TYPICAL DETAILS SHEET 4 OF 4

LOCALITY PLAN



FOR TENDER
05.04.24



DO NOT SCALE - IF IN DOUBT, ASK

ORIGINAL SIZE A1

DRAWING LAYOUT PLAN
SCALE 1 : 500

NOT FOR CONSTRUCTION



REV	DESCRIPTION	DATE	BY	CHECKED	APP
0	FOR TENDER	04.24	PJC	LG	LL
B	FOR REVIEW	03.24	KW	EG	IB
A	FOR CLIENT REVIEW	15.02.24	KW	EG	
	REVISIONS		DRN	CHK	APP

SURVEYED		
DESIGNED	Edward Guerreiro	05/23
DRAWN	Phillip J Cook	05/23
CAD REVIEW	Phillip Cook	03.04.24
DESIGN CHECK	Lachlan Goldsworthy	05.04.24
DESIGN REVIEW	Derek Chinn	05.04.24
APPROVED	Leslie Lyall	05.04.24
PROF REGISTRATION:		



Client
WANAKA LAKEFRONT DEVELOPMENT PROJECT - STAGE 5
WANAKA MARINA AND YACHT CLUB

GENERAL LAYOUT PLAN

Status Stamp	FOR TENDER
Date Stamp	05.04.24
Scales	1 : 500
Drawing No.	310103860-05-001-C001
Rev.	0

DO NOT SCALE - IF IN DOUBT, ASK

200 mm

150

100

90

80

70

60

50

40

30

20

10

0

ORIGINAL SIZE A1

GENERAL

- G1 UNLESS OTHERWISE SPECIFIED OR DETAILED ON THE DRAWINGS, THESE NOTES & DETAILS SHALL APPLY BUT INCLUSION OF THIS SHEET IN THIS CONTRACT SET DOES NOT IMPLY THAT ALL DETAILS OCCUR IN THIS CONTRACT.
- G2 THE STRUCTURAL DRAWINGS SHALL BE READ IN CONJUNCTION WITH OTHER PROJECT DRAWINGS AND WITH THE SPECIFICATIONS AND OTHER WRITTEN INSTRUCTIONS AS MAY BE ISSUED DURING THE COURSE OF THE CONTRACT.
- G3 ALL WORKMANSHIP AND MATERIALS SHALL BE IN ACCORDANCE WITH THESE NOTES UNLESS SPECIFIED OTHERWISE ON THE DRAWINGS OR PROJECT SPECIFICATIONS.
- G4 ANY DISCREPANCIES SHALL BE REFERRED TO THE ENGINEER FOR DECISION BEFORE PROCEEDING WITH THE WORK.
- G5 ALL SETOUT DIMENSIONS SHALL BE CONFIRMED AND VERIFIED ON SITE BY THE CONTRACTOR BEFORE COMMENCEMENT OF WORK. NO DIMENSIONS SHALL BE OBTAINED BY SCALING THE DRAWINGS.
- G6 DURING CONSTRUCTION THE STRUCTURE SHALL BE MAINTAINED IN A STABLE CONDITION AND NO PART SHALL BE OVER STRESSED.
- G7 ALL MATERIALS TO BE SUPPLIED BY THE CONTRACTOR UNLESS OTHERWISE SPECIFIED.
- G8 SUBSTITUTION OR AMENDMENT OF DETAILS SHALL NOT BE CARRIED OUT WITHOUT THE APPROVAL OF THE ENGINEER.
- G9 ALL DIMENSIONS ARE IN MILLIMETRES AND ALL LEVELS ARE IN METRES UNLESS NOTED OTHERWISE.
- G10 CONTRACTOR SHALL LOCATE AND POSITIVELY IDENTIFY ALL UNDERGROUND SERVICES PRIOR TO COMMENCEMENT. THE PRESENCE OF UNDERGROUND SERVICES IS UNKNOWN.
- G11 ALL DISTURBED AREAS TO BE RETURNED TO PREVIOUS STATE.
- G12 COORDINATE DATUM IS LINDIS PEAK 2000. VERTICAL DATUM IS NEW ZEALAND 2016.

STRUCTURAL STEELWORK

- S1 DESIGN CONFORMS TO NZS 3404. FABRICATION AND ERECTION SHALL BE CARRIED OUT IN ACCORDANCE WITH THE PROVISIONS OF NZS 3404.
- S2 MATERIAL: ALL STEEL SHALL BE IN ACCORDANCE WITH THE APPROPRIATE STANDARD AS OUTLINED IN NZS 3404.
- S3 GRADES OF STRUCTURAL STEEL TO BE THE FOLLOWING:
 S3.1 PLATES AND AND FLATS (AS/NZ 3678)
 THICKNESS >5mm, <= 10mm GRADE 300/GRADE 300L0/GRADE 300L15
 THICKNESS >10mm, <= 20mm GRADE 300L0/GRADE300L15
 S3.2 HOT ROLLED SECTIONS (AS/NZS 3679.1)
 FLANGE THICKNESS >5mm, <= 10mm GRADE 300/GRADE 300L0/GRADE 300L15
 FLANGE THICKNESS >10mm, <= 20mm GRADE 300L0/GRADE300L15
- S4 BOLTING: ALL BOLTS, NUTS AND WASHERS THAT ARE NOT IN CONTACT WITH TANALISED TIMBER SHALL BE HOT DIPPED GALVANISED BY THE MANUFACTURER TO CONFORM TO AS 1214. ALL BOLTS THAT ARE IN CONTACT WITH TANALISED TIMBER SHALL BE 316 STAINLESS STEEL. BOLTING PROCEDURES ARE IDENTIFIED AS FOLLOWS:

BOLTING PROCEDURE	BOLT STRENGTH GRADE	BOLT TO AS/NZS STANDARD	METHOD OF INSTALLATION
4.6/S	4.6	AS/NZS 1111	SNUG TIGHTENED

- S5 ALL BOLTS SHALL HAVE AT LEAST ONE THREAD PROJECTING THROUGH BOTH SIDES OF NUT.
- S6 ALL HOLES SHALL BE DRILLED AND SHALL BE 2mm LARGER THAN BOLT DIAMETER UNLESS NOTED OTHERWISE.
- S7 EPOXY GROUTED ANCHORS INTO CONCRETE SHALL BE INSTALLED AND TIGHTENED IN ACCORDANCE WITH THE MANUFACTURERS WRITTEN RECOMMENDATIONS.
- S8 ALL SNUG TIGHT BOLTS TO HAVE LOCTITE 243 OR SIMILAR APPROVED IN ACCORDANCE WITH THE SUPPLIERS RECOMMENDATIONS.
- S9 SITE DRILLED STEEL SHALL BE COATED WITH ZINCFIX IN ACCORDANCE WITH MANUFACTURERS SPECIFICATIONS.
- S10 ALL STEEL FOR TOILET BLOCK SCREENING TO BE STEEL TO BE PAINTED IN ACCORDANCE WITH THE FOLLOWING SPECIFICATION:
 PREPARATION REFER TO RESENE SIPDS No. 4 METAL / STEEL AND SPEC SHEET 4:1HP/1
 PRIMER / SEALER RESENE ARMOURZINC 120 - ZINC EPOXY PRIMER APPLIED TO ACHIEVE A RA22 DFT OF 75 MICRONS
 RESENE ARMOURCOTE 510 - HIGH SOLIDS EPOXY APPLIED TO ACHIEVE A RA40 DFT OF 200 MICRONS
 TOPCOAT SYSTEM 2 COATS OF RESENE URACRYL 404 - LOW SHEEN APPLIED TO ACHIEVE A RA59 TOTAL DRY FILM THICKNESS OF 100 MICRONS
 COLOUR RESENE "IRONSAND" OR SIMILARLY APPROVED DARK GREY COLOUR WITH LRV BETWEEN 8% AND 12%.

PILING

- P1 ALL PILING TO BE SUPERVISED BY A GEOTECHNICAL ENGINEER.
- P2 PILING DEPTHS TO BE VERIFIED / CONFIRMED ON SITE.
- P3 PILING SHALL BE COMPLETED IN ACCORDANCE WITH SESOC/NZGS SPECIFICATION FOR BORED PILES.

EARTHWORKS

- E1 ALL EARTHWORKS SHALL BE CARRIED OUT IN STRICT ACCORDANCE WITH THESE DRAWINGS.
- E2 ALL EXCAVATED FOUNDATIONS ARE TO BE INSPECTED BY A GEOTECHNICAL ENGINEER PRIOR TO PROCEEDING.
- E3 EXCAVATED MATERIAL SHALL ONLY BE INCORPORATED IN THE WORKS ONCE THE ENGINEER HAS INSPECTED AND APPROVED MATERIAL FOR REUSE.
- E4 CONTRACTOR SHALL DEVISE A SUITABLE SYSTEM TO CONTROL GROUND WATER INTO EXCAVATIONS AND TO MEET RESOURCE CONSENT(S) REQUIREMENTS.
- E5 ALL IMPORTED FILL SHALL BE APPROVED BY THE ENGINEER PRIOR TO PLACEMENT.
- E6 FILL MATERIAL SHALL BE PLACED AND COMPACTED IN LINE WITH THE PROJECT SPECIFICATION.

CONCRETE

- C1 ALL WORKMANSHIP AND MATERIALS SHALL BE IN ACCORDANCE WITH NZS 3109 AND OTHER RELEVANT CODES.
- C2 CONCRETE STRENGTH

STRUCTURAL ELEMENT	NZS 3109 f _c TARGET STRENGTH	MAX. SIZE AGGREGATE
FOOTPATH	30 MPa	13mm
KERBING	20 MPa	20mm
RETAINING WALL PILES	25 MPa	20mm

- C3 MINIMUM REQUIRED CONCRETE COVER TO REINFORCING STEEL SHALL BE AS FOLLOWS (UNLESS NOTED OTHERWISE)

STRUCTURAL ELEMENT	MINIMUM REQUIRED COVER (mm) UNLESS NOTED OTHERWISE
CONCRETE CAST AGAINST GROUND	75
CONCRETE CAST AGAINST FORMWORK	50

- C4 CONSTRUCTION JOINTS SHALL BE LOCATED AS SHOWN ON THE DRAWINGS AND SHALL BE " TYPE B" AS DEFINED IN NZS 3109 UNLESS NOTED OTHERWISE.
- C5 NO HOLES OR CHASES OTHER THAN THOSE SHOWN ON THE STRUCTURAL DRAWINGS SHALL BE MADE IN CONCRETE MEMBERS WITHOUT THE PRIOR APPROVAL OF THE ENGINEER.
- C6 ALL FORMED EXPOSED EDGES AND RE-ENTRANT CORNERS SHALL BE CHAMFERED OR FILLETED 5mm UNLESS NOTED OTHERWISE.
- C7 TOLERANCES FOR INSITU WORK SHALL CONFORM WITH THE SPECIFICATION.
- C8 ALL CONCRETE SHALL BE PLACED IN THE DRY.
- C9 ALL CONCRETE TO BE WELL VIBRATED AND CURED.

TIMBER

- T1 ALL TIMBER CONSTRUCTION SHALL BE CARRIED OUT IN ACCORDANCE WITH NZS3604:2011 AND NZS3603:1993.
- T2 ALL TIMBER SHALL BE PINUS RADIATA .
- T3 ALL TIMBER SHALL BE ROUGH SAWN.
- T4 ALL GENERAL PURPOSE NAILS SHALL BE 90x4.0 STAINLESS STEEL FLAT HEAD NAILS IN ACCORDANCE WITH NZS3603:1993 U.N.O.
- T5 ALL CONCRETE AND/OR STEEL SHALL BE ISOLATED FROM TIMBER WITH A MALTHOID DPC STRIP.
- T6 ALL CUT ENDS OF TIMBER SHALL BE TREATED WITH METALEX OF SIMILAR APPROVED AND APPLIED IN ACCORDANCE WITH THE MANUFACTURERS SPECIFICATIONS.
- T7 ALL TIMBER FOR TOILET BLOCK SCREENING TO BE STAINED WITH RESENE WATERBORNE WOODSMAN IN ACCORDANCE WITH RESENE TECHNICAL PRODUCT DATA SHEET D57a. COLOUR SHALL BE CHOSEN TO MATCH EXISTING STRUCTURE AS CLOSE AS POSSIBLE.

CONCRETE FOOTPATH

- FP1 EXPOSED AGGREGATE TO BE AS PER NZS 3121. CRUSHED OR PEBBLE/ROUND AGGREGATES FOR EXPOSING, TO BE GAP GRADED FOR INTEGRAL MIXES.
- FP2 SURFACE RETARDER TO BE PROPRIETARY SPRAY ON CHEMICAL TO SLOW DOWN THE SURFACE SET FOR EXPOSING AGGREGATE.
- FP3 SPRAY RETARDER ON SLAB TO MANUFACTURERS RECOMMENDATIONS AND LEAVE FOR THE PRESCRIBED TIME TO PROVIDE DESIRED EXPOSURE DEPTH. AT THE APPROPRIATE TIME USE A SUITABLE MILD ACID WASH TO REMOVE SURFACE CEMENT PASTE. WASH THOROUGHLY WITH WATER.
- FP4 CONCRETE SELECTION:
 OXIDE: 5% PETER FELL COLOUR #162
 AGGREGATE SOURCE: FIRTH
 AGGREGATE NAME/SHAPE: AMISFEILD UNWASHED
 MAXIMUM SIZE/GRADING: 13mm
 EXPOSURE DEPTH: LIGHTLY EXPOSED
 ADDING METHOD: INTEGRAL
 EXPOSING METHOD: RETARDER AND WASH
 SEALANT: PERMACOLOUR CONCRETE SEALER

RETAINING WALL

- W1 TEMPORARY STABILITY OF THE EMBANKMENT IS THE RESPONSIBILITY OF THE CONTRACTOR.
- W2 ACTUAL RETAINED HEIGHT SHALL BE MEASURED AT EACH PILE LOCATION AND THE CORRECT PILE EMBEDMENT DEPTH AND HEIGHT FOR EACH PILE SHALL BE SELECTED FROM THE TABLE.
- W3 PRIOR TO UNDERTAKING ANY EARTHWORKS, THE CONTRACTOR MUST PROVIDE A METHOD STATEMENT FOR THE ENGINEERS APPROVAL. THIS MUST INDICATE HOW THE WORKS WILL BE CARRIED OUT WHILST MAINTAINING TEMPORARY STABILITY.
- W4 INSITU MATERIAL IS ANTICIPATED TO BE DENSE GRAVELS AND NO GROUND WATER IS ANTICIPATED IN THE PROPOSED CUT.
- W5 CASING OF HOLES MAY BE REQUIRED IF GRAVELS DO NOT HOLD DURING DRILLING.
- W6 ANTICIPATED GROUNDWATER LEVEL IS BELOW THE EMBEDDED PILE DEPTH.
- W7 CONTACT ENGINEER IF GROUNDWATER IS ENCOUNTERED.
- W8 PILE HOLES MAY BE DRILLED VERTICALLY. GREATER DIAMETER WILL BE REQUIRED TO ENSURE MIN 50mm COVER TO ALL SIDES OF UC.
- W9 BACKFILL IS TO BE FREE DRAINING, NON PLASTIC GRANULAR MATERIAL WITH FRICTION ANGLES BETWEEN 27 AND 40 DEGREES (PEA GRAVEL OR APPROVED EQUIVALENT).
- W10 FILTER CLOTH (BIDIM A29 OR APPROVED EQUIVALENT) SHALL LINE THE FREE DRAINING RETAINING WALL BACKFILL MATERIAL TO PREVENT MIGRATION OF FINES.
- W11 ALL CONNECTIONS INCLUDING JOINING OF LENGTHS OF DRAIN COIL SHALL BE MADE USING MANUFACTURERS FITTINGS.
- W12 THE DRAIN COIL SHALL MAINTAIN CONTINUOUS FALL TO THE CULVERT UNDER THE EELY POINT TRACK FOR THE WHOLE LENGTH OF THE RETAINING WALL.
- W13 DRAIN COIL TO BE ENCASED WITH GEOFABRIC (BIDIM A20 OR APPROVED EQUIVALENT).
- W14 ALL DIMENSIONS IN MILLIMETERS UNLESS NOTED OTHERWISE

NOT FOR CONSTRUCTION

				SURVEYED		Client		WANAKA LAKEFRONT DEVELOPMENT PROJECT - STAGE 5		Status Stamp	
				DESIGNED		Edward Guerreiro		WANAKA MARINA AND YACHT CLUB		FOR TENDER	
				DRAWN		Phillip J Cook				Date Stamp	
				CAD REVIEW		Phillip Cook				05.04.24	
				DESIGN CHECK		Lachlan Goldsworthy				Scales NOT TO SCALE	
				DESIGN REVIEW		Derek Chinn				Drawing No.	
				APPROVED		Leslie Lyall				310103860-05-001-C002	
				PROF REGISTRATION:						Rev. 0	
0 FOR TENDER		PJC LG LL 04 24									
A FOR CLIENT REVIEW		KW EG 02 24									
REV		DRN CHK APP DATE									

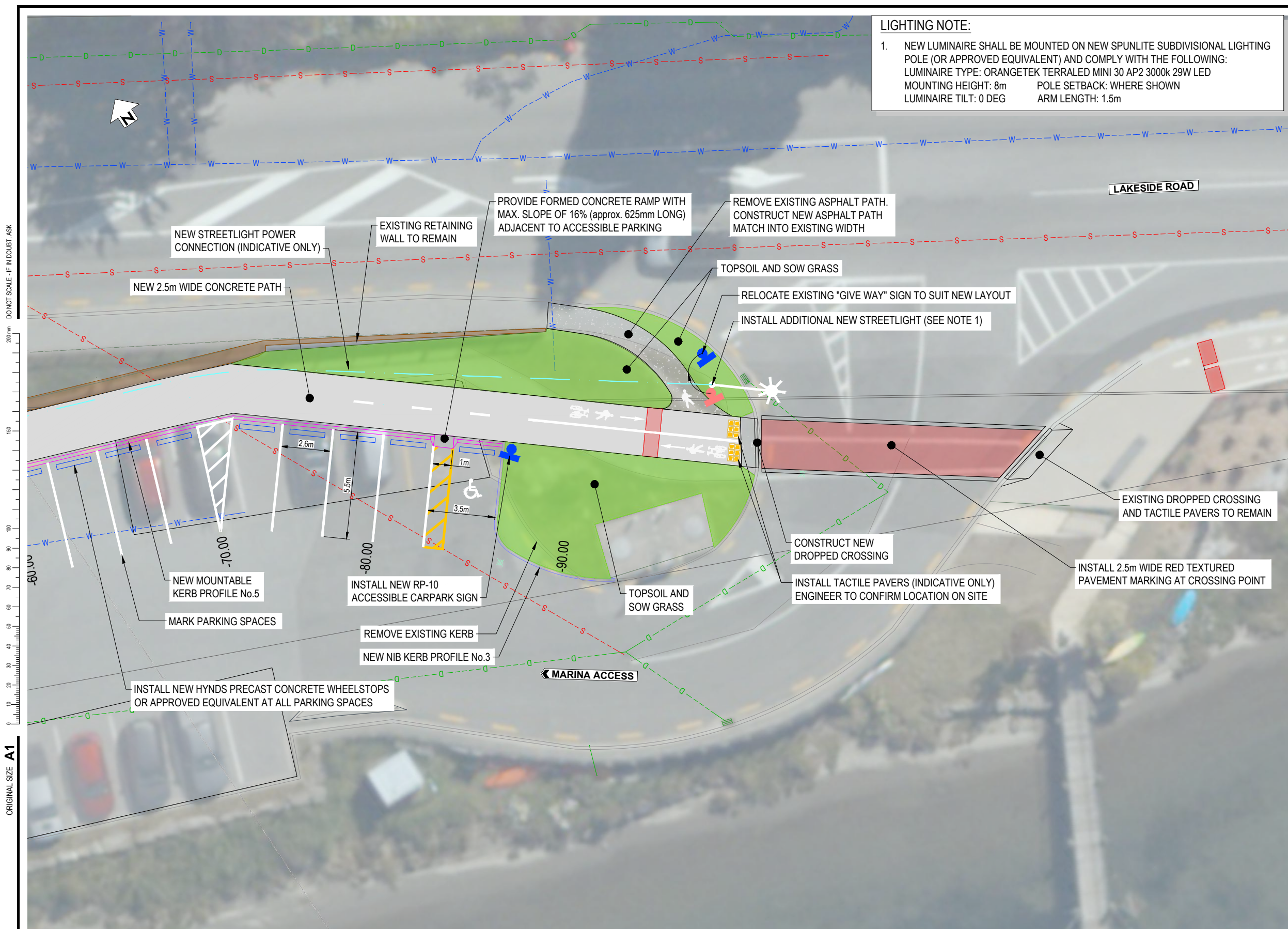

LIGHTING NOTE:

1. NEW LUMINAIRE SHALL BE MOUNTED ON NEW SPUNLITE SUBDIVISIONAL LIGHTING POLE (OR APPROVED EQUIVALENT) AND COMPLY WITH THE FOLLOWING:
 LUMINAIRE TYPE: ORANGETEK TERRALED MINI 30 AP2 3000k 29W LED
 MOUNTING HEIGHT: 8m POLE SETBACK: WHERE SHOWN
 LUMINAIRE TILT: 0 DEG ARM LENGTH: 1.5m

LEGEND

- NEW CONCRETE PATH
- NEW REINFORCED CONCRETE PATH
- NEW TOPSOIL AND SOW GRASS
- NEW TOPSOIL AND LOW PLANTING ≤1.2m
- REGRADE GRAVEL - NO MORE THAN 6%
- NEW NIB KERB - QLDC No.3
- NEW MOUNTABLE KERB - QLDC No.5
- NEW RETAINING WALL
- NEW BARRIER/HANDRAIL
- NEW BOLLARD
- NEW PRAM CROSSING

EXISTING SERVICES

- WATER SUPPLY
- FIRE HYDRANT
- VALVE
- TOBY
- WASTEWATER GRAVITY
- WASTEWATER MANHOLE
- STORMWATER
- STORMWATER MANHOLE
- STORMWATER SWALE

ORIGINAL SIZE A1

PLAN
SCALE 1 : 100

SCALE 1:100

NOT FOR CONSTRUCTION

REV	DESCRIPTION	DATE	APP	CHK	DRN
0	FOR TENDER	04.24	PJC	LG	LL
B	FOR CLIENT REVIEW	15.02.24	KW	EG	
A	FOR CLIENT REVIEW	08.23	PJC	EG	
	REVISIONS		DRN	CHK	APP

STATUS	NAME	DATE
SURVEYED		
DESIGNED	Edward Guerreiro	05/23
DRAWN	Phillip J Cook	05/23
CAD REVIEW	Phillip Cook	03.04.24
DESIGN CHECK	Lachlan Goldsworthy	05.04.24
DESIGN REVIEW	Derek Chinn	05.04.24
APPROVED	Leslie Lyall	05.04.24
PROF REGISTRATION:		

Client

WANAKA LAKEFRONT DEVELOPMENT PROJECT - STAGE 5
WANAKA MARINA AND YACHT CLUB

SEGMENT 1 LAYOUT PLAN

Status Stamp	FOR TENDER
Date Stamp	05.04.24
Scales	1 : 100
Drawing No.	310103860-05-001-C101
Rev.	0

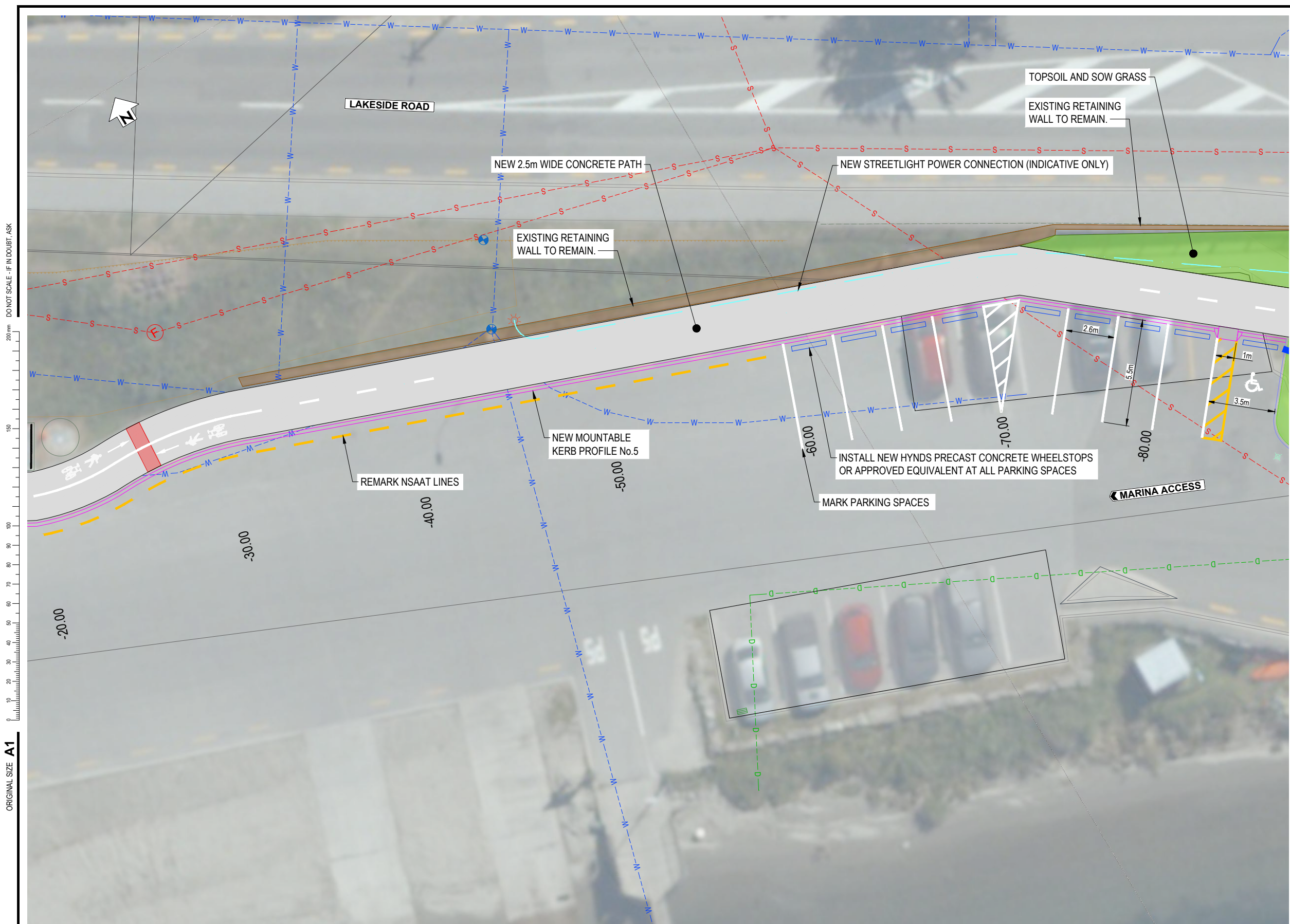

LEGEND

- NEW CONCRETE PATH
- NEW REINFORCED CONCRETE PATH
- NEW TOPSOIL AND SOW GRASS
- NEW TOPSOIL AND LOW PLANTING ≤1.2m
- REGRADE GRAVEL - NO MORE THAN 6%
- NEW NIB KERB - QLDC No.3
- NEW MOUNTABLE KERB - QLDC No.5
- NEW RETAINING WALL
- NEW BARRIER/HANDRAIL
- NEW BOLLARD
- NEW PRAM CROSSING

EXISTING SERVICES

- WATER SUPPLY
- FIRE HYDRANT
- VALVE
- TOBY
- WASTEWATER GRAVITY
- WASTEWATER MANHOLE
- STORMWATER
- STORMWATER MANHOLE
- STORMWATER SWALE

ORIGINAL SIZE A1

DO NOT SCALE - IF IN DOUBT, ASK

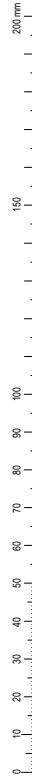

PLAN
SCALE 1 : 100



REV	DESCRIPTION	DATE	APP	CHK	DRN
0	FOR TENDER	04.24	PJC	LG	LL
B	FOR REVIEW	03.24	KW	EG	IB
A	FOR CLIENT REVIEW	15.02.24	KW	EG	IB
REV	REVISIONS	DATE	DRN	CHK	APP

STATUS	NAME	DATE
SURVEYED	Edward Guerreiro	05/23
DESIGNED	Phillip J Cook	05/23
CAD REVIEW	Phillip Cook	03.04.24
DESIGN CHECK	Lachlan Goldsworthy	05.04.24
DESIGN REVIEW	Derek Chinn	05.04.24
APPROVED	Leslie Lyall	05.04.24



WANAKA LAKEFRONT DEVELOPMENT PROJECT - STAGE 5
WANAKA MARINA AND YACHT CLUB

SEGMENT 2 LAYOUT PLAN
SHEET 1

Status Stamp	FOR TENDER
Date Stamp	05.04.24
Scales	1 : 100
Drawing No.	310103860-05-001-C102
Rev.	0

NOT FOR CONSTRUCTION

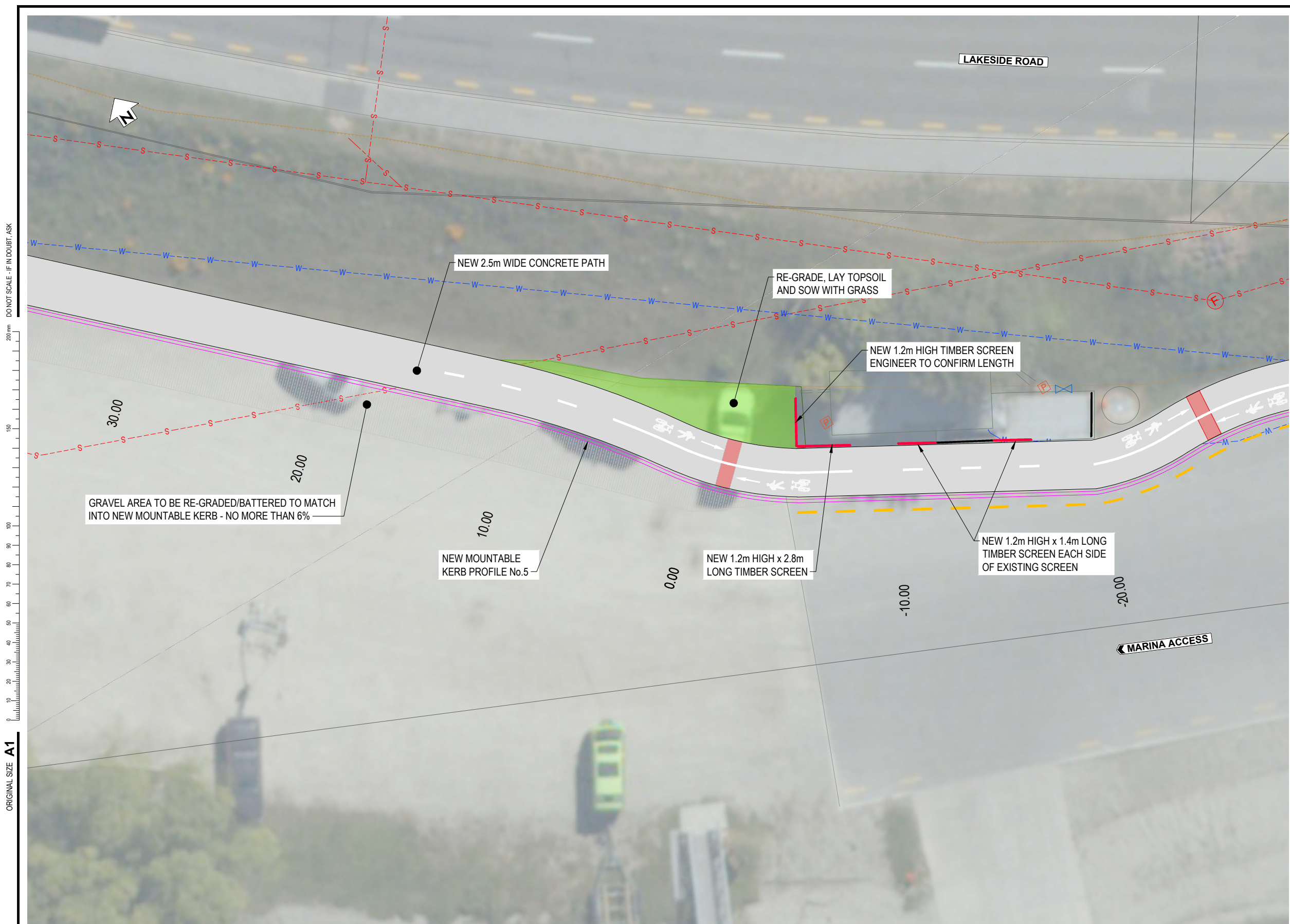

LEGEND

- NEW CONCRETE PATH
- NEW REINFORCED CONCRETE PATH
- NEW TOPSOIL AND SOW GRASS
- NEW TOPSOIL AND LOW PLANTING ≤1.2m
- REGRADE GRAVEL - NO MORE THAN 6%
- NEW NIB KERB - QLDC No.3
- NEW MOUNTABLE KERB - QLDC No.5
- NEW RETAINING WALL
- NEW BARRIER/HANDRAIL
- NEW BOLLARD
- NEW PRAM CROSSING

EXISTING SERVICES

- WATER SUPPLY W
- FIRE HYDRANT
- VALVE
- TOBY
- WASTEWATER GRAVITY
- WASTEWATER MANHOLE
- STORMWATER
- STORMWATER MANHOLE
- STORMWATER SWALE

ORIGINAL SIZE A1

DO NOT SCALE - IF IN DOUBT, ASK

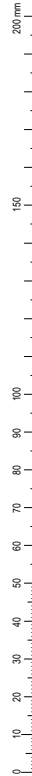

PLAN
SCALE 1 : 100



NOT FOR CONSTRUCTION

REV	DESCRIPTION	DATE	APP	CHK	DRN
0	FOR TENDER	04.24	PJC	LG	LL
B	FOR CLIENT REVIEW	15.02.24	KW	EG	
A	FOR CLIENT REVIEW	08/23	PJC	EG	
	REVISIONS		DRN	CHK	APP

STATUS	NAME	DATE
SURVEYED		
DESIGNED	Edward Guerreiro	05/23
DRAWN	Phillip J Cook	05/23
CAD REVIEW	Phillip Cook	03.04.24
DESIGN CHECK	Lachlan Goldsworthy	05.04.24
DESIGN REVIEW	Derek Chinn	05.04.24
APPROVED	Leslie Lyall	05.04.24
PROF REGISTRATION:		

WANAKA LAKEFRONT DEVELOPMENT PROJECT - STAGE 5
WANAKA MARINA AND YACHT CLUB

SEGMENT 2 LAYOUT PLAN
SHEET 2

Status Stamp	FOR TENDER
Date Stamp	05.04.24
Scales	1 : 100
Drawing No.	310103860-05-001-C103
Rev.	0

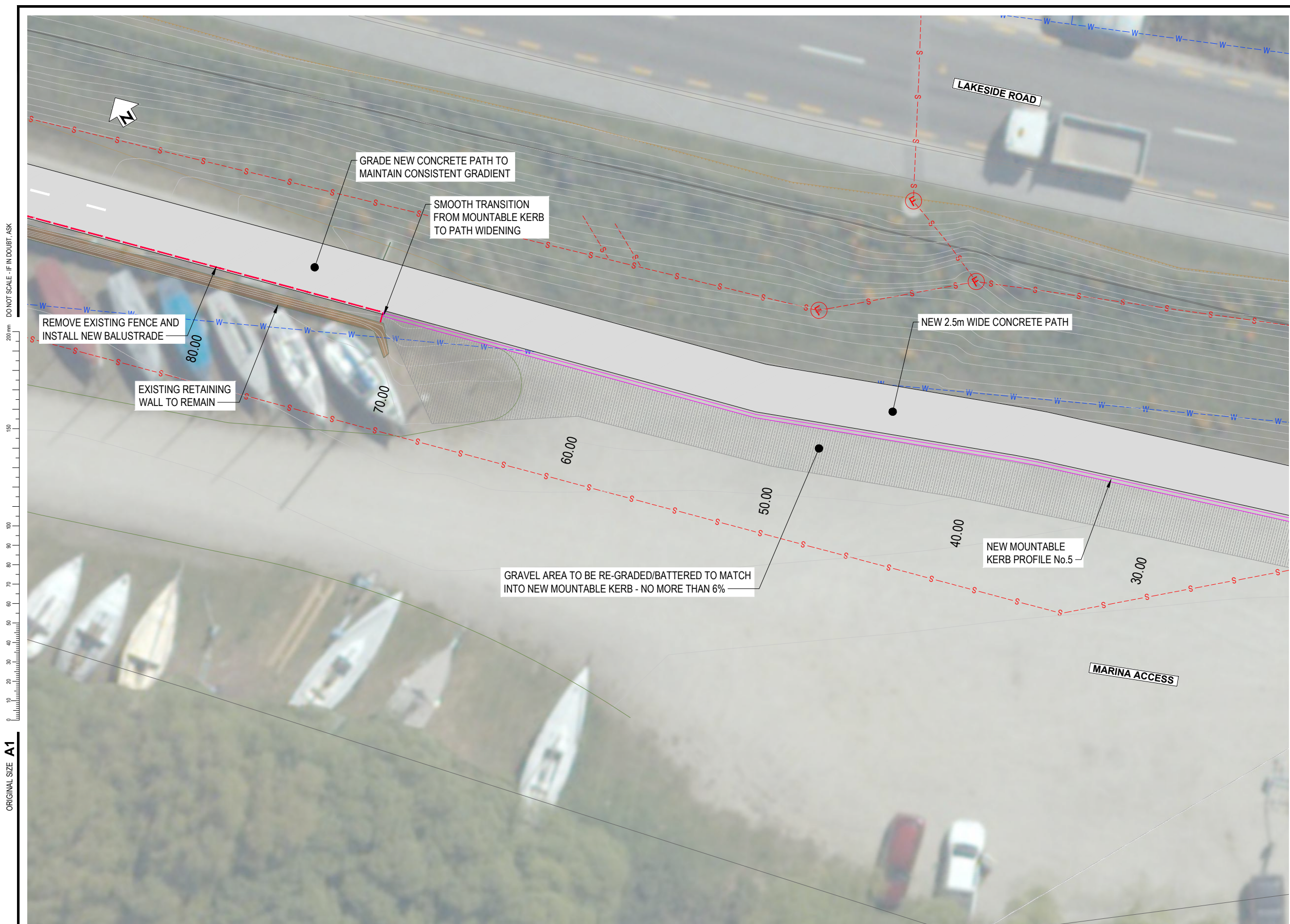

LEGEND

- NEW CONCRETE PATH
- NEW REINFORCED CONCRETE PATH
- NEW TOPSOIL AND SOW GRASS
- NEW TOPSOIL AND LOW PLANTING ≤1.2m
- REGRADE GRAVEL - NO MORE THAN 6%
- NEW NIB KERB - QLDC No.3
- NEW MOUNTABLE KERB - QLDC No.5
- NEW RETAINING WALL
- NEW BARRIER/HANDRAIL
- NEW BOLLARD
- NEW PRAM CROSSING

EXISTING SERVICES

- WATER SUPPLY
- FIRE HYDRANT
- VALVE
- TOBY
- WASTEWATER GRAVITY
- WASTEWATER MANHOLE
- STORMWATER
- STORMWATER MANHOLE
- STORMWATER SWALE

DO NOT SCALE - IF IN DOUBT, ASK

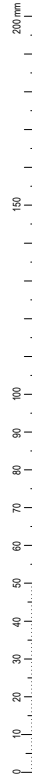

ORIGINAL SIZE A1

PLAN
SCALE 1 : 100



NOT FOR CONSTRUCTION

REV	DESCRIPTION	DATE	APP	CHK	DRN
0	FOR TENDER	04.24	PJC	LG	LL
B	FOR CLIENT REVIEW	15.02.24	KW	EG	
A	FOR CLIENT REVIEW	08/23	PJC	EG	
	REVISIONS		DRN	CHK	APP

STATUS	NAME	DATE
SURVEYED		
DESIGNED	Edward Guerreiro	05/23
DRAWN	Phillip J Cook	05/23
CAD REVIEW	Phillip Cook	03.04.24
DESIGN CHECK	Lachlan Goldsworthy	05.04.24
DESIGN REVIEW	Derek Chinn	05.04.24
APPROVED	Leslie Lyall	05.04.24
PROF REGISTRATION:		



WANAKA LAKEFRONT DEVELOPMENT PROJECT - STAGE 5
WANAKA MARINA AND YACHT CLUB

SEGMENT 2 LAYOUT PLAN
SHEET 3

Status Stamp	FOR TENDER
Date Stamp	05.04.24
Scales	1 : 100
Drawing No.	310103860-05-001-C104
Rev.	0

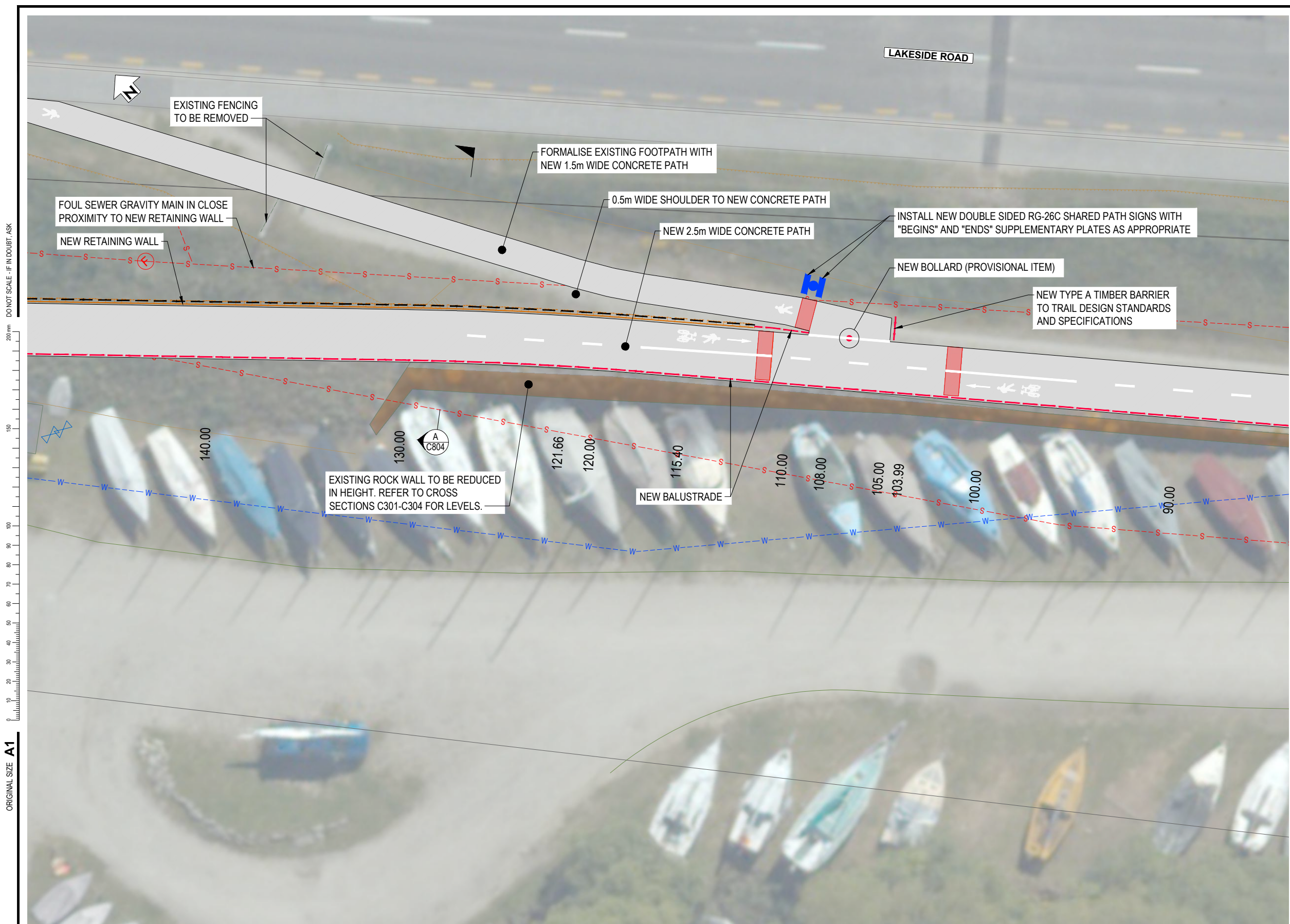

LEGEND

- NEW CONCRETE PATH
- NEW REINFORCED CONCRETE PATH
- NEW TOPSOIL AND SOW GRASS
- NEW TOPSOIL AND LOW PLANTING ≤1.2m
- REGRADE GRAVEL - NO MORE THAN 6%
- NEW NIB KERB - QLDC No.3
- NEW MOUNTABLE KERB - QLDC No.5
- NEW RETAINING WALL
- NEW BARRIER/HANDRAIL
- NEW BOLLARD
- NEW PRAM CROSSING

EXISTING SERVICES

- WATER SUPPLY
- FIRE HYDRANT
- VALVE
- TOBY
- WASTEWATER GRAVITY
- WASTEWATER MANHOLE
- STORMWATER
- STORMWATER MANHOLE
- STORMWATER SWALE

PLAN
SCALE 1 : 100



NOT FOR CONSTRUCTION

REV	DESCRIPTION	DATE	APP	CHK	DRN
0	FOR TENDER	04.24	PJC	LG	LL
B	FOR CLIENT REVIEW	15.02.24	PJC	EG	
A	FOR CLIENT REVIEW	08.23	PJC	EG	
	REVISIONS		DRN	CHK	APP

STATUS	NAME	DATE
SURVEYED		
DESIGNED	Edward Guerreiro	05/23
DRAWN	Phillip J Cook	05/23
CAD REVIEW	Phillip Cook	04.04.24
DESIGN CHECK	Lachlan Goldsworthy	05.04.24
DESIGN REVIEW	Derek Chinn	05.04.24
APPROVED	Leslie Lyall	05.04.24
PROF REGISTRATION:		

Client

WANAKA LAKEFRONT DEVELOPMENT PROJECT - STAGE 5
 WANAKA MARINA AND YACHT CLUB

SEGMENT 3 LAYOUT PLAN
 SHEET 1

Status Stamp	FOR TENDER
Date Stamp	05.04.24
Scales	1 : 100
Drawing No.	310103860-05-001-C105
Rev.	0

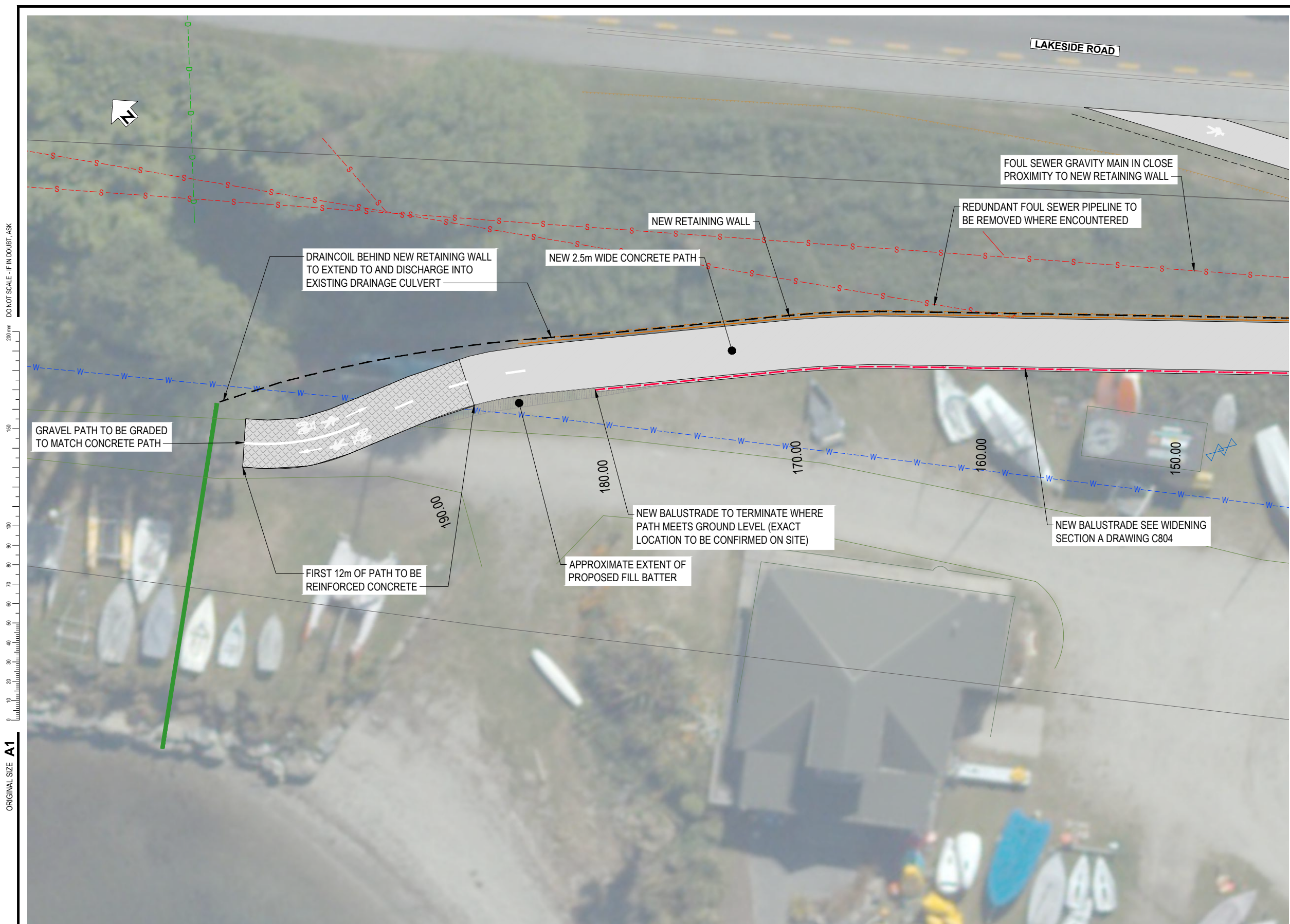

LEGEND

- NEW CONCRETE PATH
- NEW REINFORCED CONCRETE PATH
- NEW TOPSOIL AND SOW GRASS
- NEW TOPSOIL AND LOW PLANTING ≤1.2m
- REGRADE GRAVEL - NO MORE THAN 6%
- NEW NIB KERB - QLDC No.3
- NEW MOUNTABLE KERB - QLDC No.5
- NEW RETAINING WALL
- NEW BARRIER/HANDRAIL
- NEW BOLLARD
- NEW PRAM CROSSING

EXISTING SERVICES

- WATER SUPPLY
- FIRE HYDRANT
- VALVE
- TOBY
- WASTEWATER GRAVITY
- WASTEWATER MANHOLE
- STORMWATER
- STORMWATER MANHOLE
- STORMWATER SWALE

ORIGINAL SIZE A1

DO NOT SCALE - IF IN DOUBT, ASK

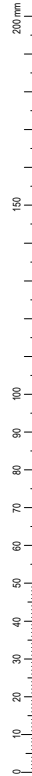

PLAN
SCALE 1 : 100



NOT FOR CONSTRUCTION

REV	DESCRIPTION	DATE	APP	CHK	DRN
0	FOR TENDER	04.24	PJC	LG	LL
B	FOR CLIENT REVIEW	15.02.24	KW	EG	
A	FOR CLIENT REVIEW	08.23	PJC	EG	
	REVISIONS		DRN	CHK	APP

STATUS	NAME	DATE
SURVEYED		
DESIGNED	Edward Guerreiro	05/23
DRAWN	Phillip J Cook	05/23
CAD REVIEW	Phillip Cook	04.04.24
DESIGN CHECK	Lachlan Goldsworthy	05.04.24
DESIGN REVIEW	Derek Chinn	05.04.24
APPROVED	Leslie Lyall	05.04.24



WANAKA LAKEFRONT DEVELOPMENT PROJECT - STAGE 5
WANAKA MARINA AND YACHT CLUB

SEGMENT 3 LAYOUT PLAN
SHEET 2

Status Stamp	FOR TENDER
Date Stamp	05.04.24
Scales	1 : 100
Drawing No.	310103860-05-001-C106
Rev.	0

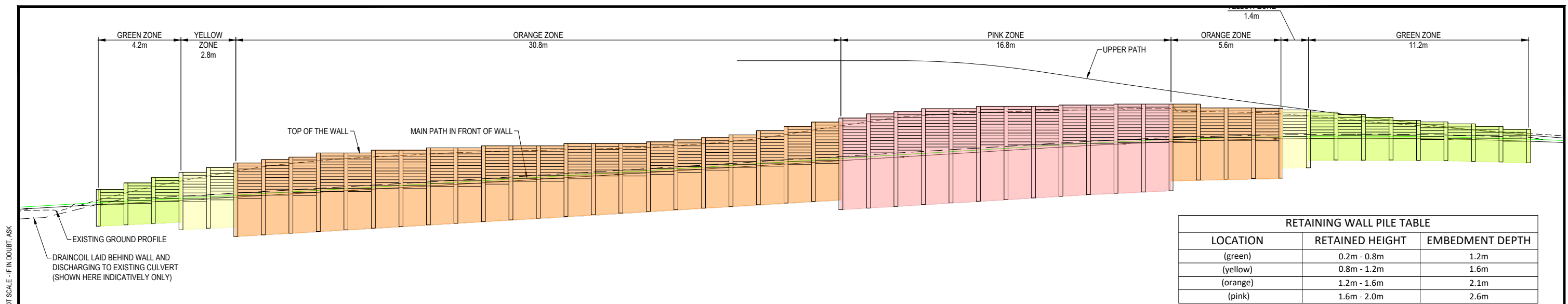

RETAINING WALL PILE TABLE		
LOCATION	RETAINED HEIGHT	EMBEDMENT DEPTH
(green)	0.2m - 0.8m	1.2m
(yellow)	0.8m - 1.2m	1.6m
(orange)	1.2m - 1.6m	2.1m
(pink)	1.6m - 2.0m	2.6m

DO NOT SCALE - IF IN DOUBT, ASK

ORIGINAL SIZE A1

200 mm

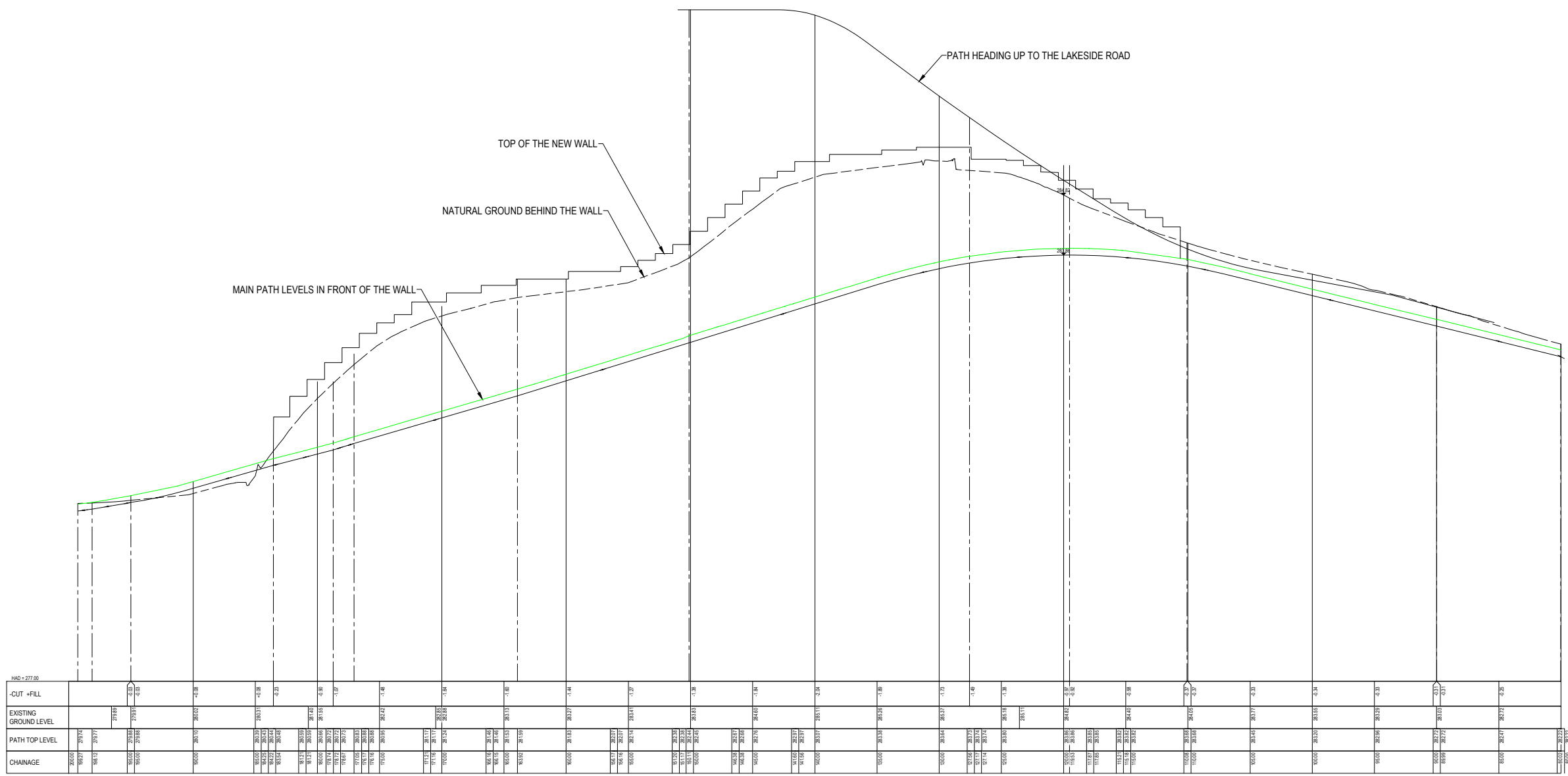

LONGITUDINAL SECTION
 SCALES - H 1 : 200
 V 1 : 40

NOT FOR CONSTRUCTION

REV	DESCRIPTION	PJC	LG	LL	DATE
0	FOR TENDER				04 24
A	FOR CLIENT REVIEW	KW	EG	IB	02 24
		DRN	CHK	APP	DATE

DESCRIPTION	BY	DATE
SURVEYED		
DESIGNED	Edward Guerreiro	05/23
DRAWN	Kerry Ware	02/2024
CAD REVIEW	Phillip Cook	04.04.24
DESIGN CHECK	Lachlan Goldsworthy	05.04.24
DESIGN REVIEW	Derek Chinn	05.04.24
APPROVED	Leslie Lyall	05.04.24



Client
WANAKA LAKEFRONT DEVELOPMENT PROJECT - STAGE 5
WANAKA MARINA AND YACHT CLUB
 RETAINING WALL AND PATH LONGITUDINAL SECTION

Status Stamp	FOR TENDER
Date Stamp	05.04.24
Scales	AS SHOWN
Drawing No.	310103860-05-001-C201
Rev.	0

DO NOT SCALE - IF IN DOUBT, ASK

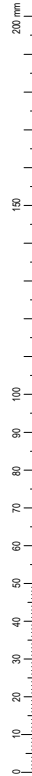

ORIGINAL SIZE A1

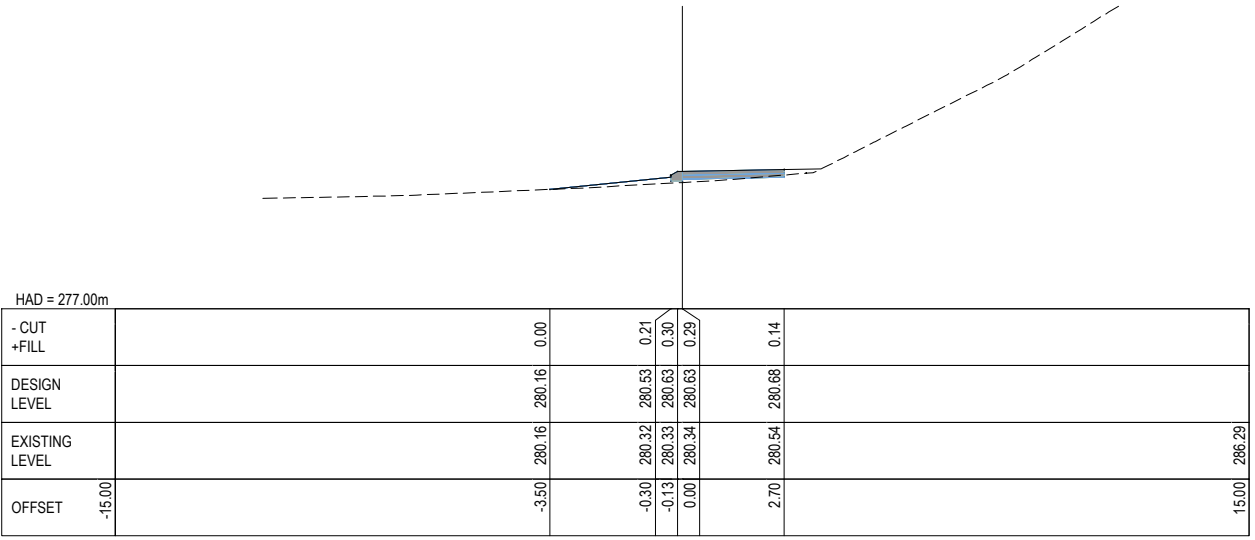

20.00

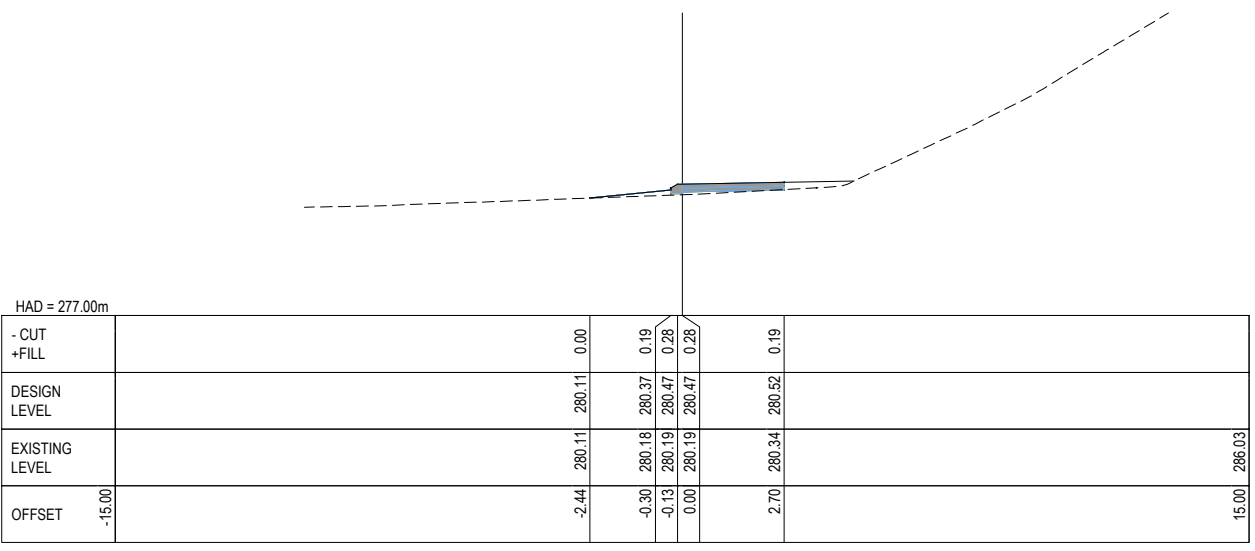

10.00

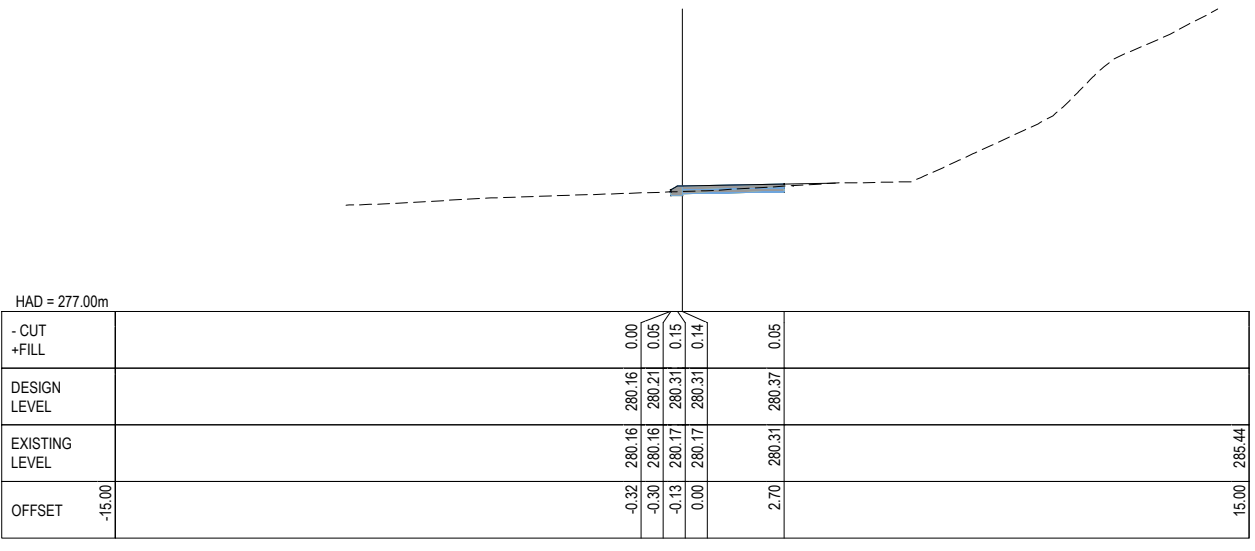

0.00

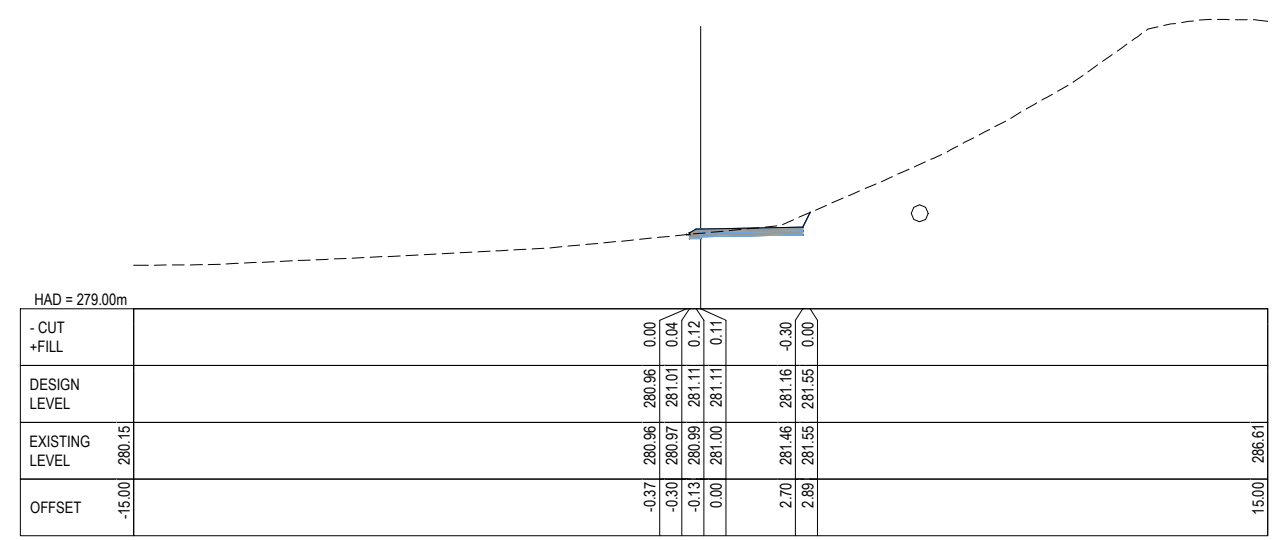

50.00

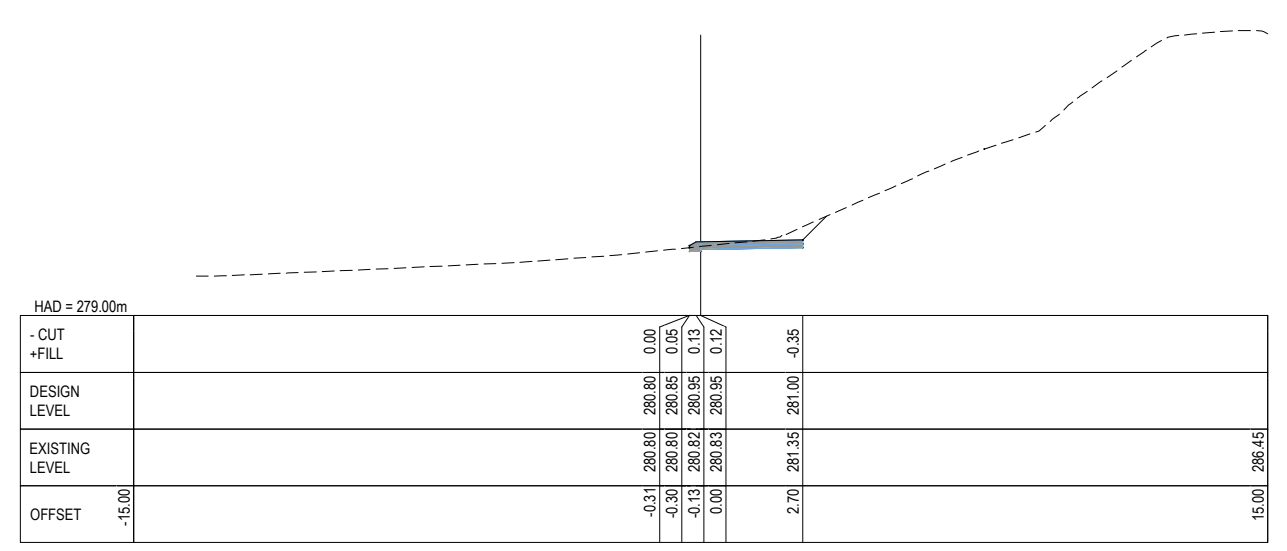

40.00

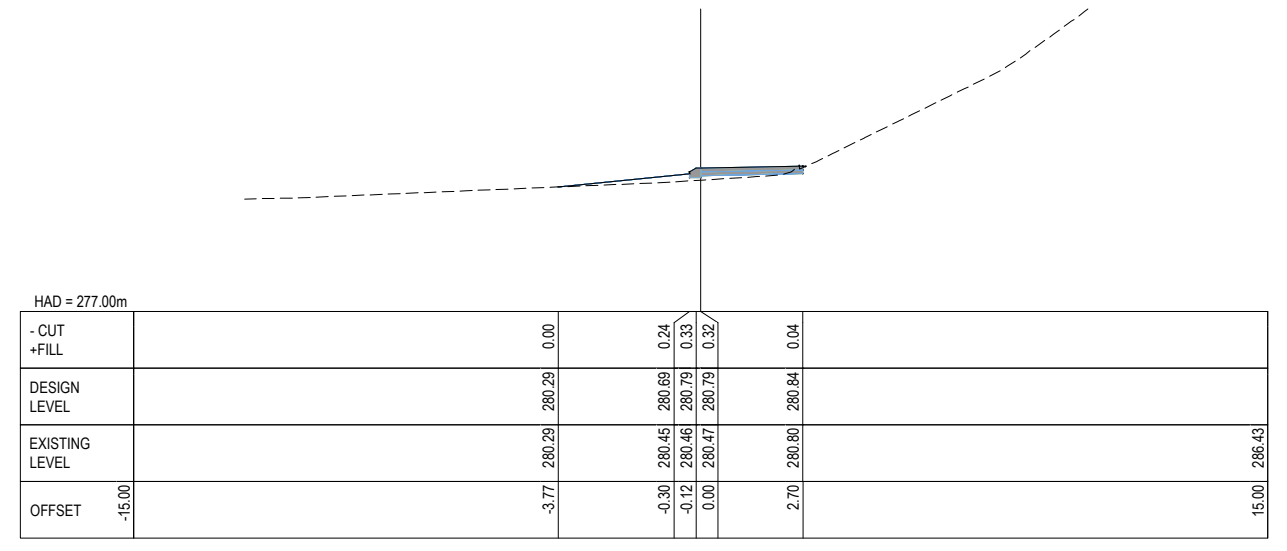

30.00

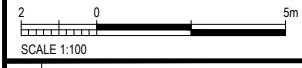

REV	DESCRIPTION	PJC	LG	LL	DATE
0	FOR TENDER				04.24
A	FOR CLIENT REVIEW				02.24

SURVEYED	DESIGNED	DRAWN	CAD REVIEW	DESIGN CHECK	DESIGN REVIEW	APPROVED	PROF REGISTRATION:
	Edward Guerreiro	Kerry Ware	Phillip Cook	Lachlan Goldsworthy	Derek Chinn	Leslie Lyall	



Client: WANAKA LAKEFRONT DEVELOPMENT PROJECT - STAGE 5
 WANAKA MARINA AND YACHT CLUB
 PATH CROSS-SECTIONS
 SHEET 1 OF 4

NOT FOR CONSTRUCTION

Status Stamp	FOR TENDER
Date Stamp	05.04.24
Scales	AS SHOWN
Drawing No.	310103860-05-001-C301
Rev.	0

DO NOT SCALE - IF IN DOUBT, ASK

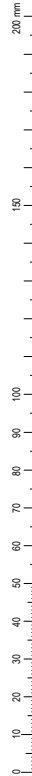

ORIGINAL SIZE A1

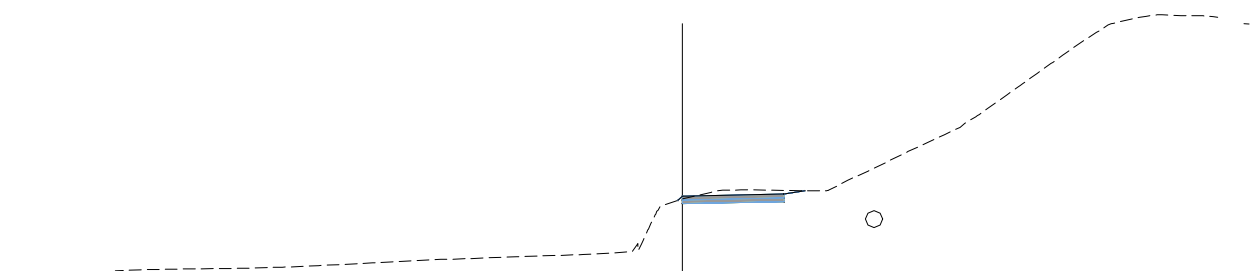

HAD = 279.00m					
- CUT +FILL			0.00	0.07	
DESIGN LEVEL		282.16	282.27		
EXISTING LEVEL	280.30	282.16	282.20	282.41	286.83
OFFSET	-15.00	-0.11	0.00	2.70	3.24

80.00

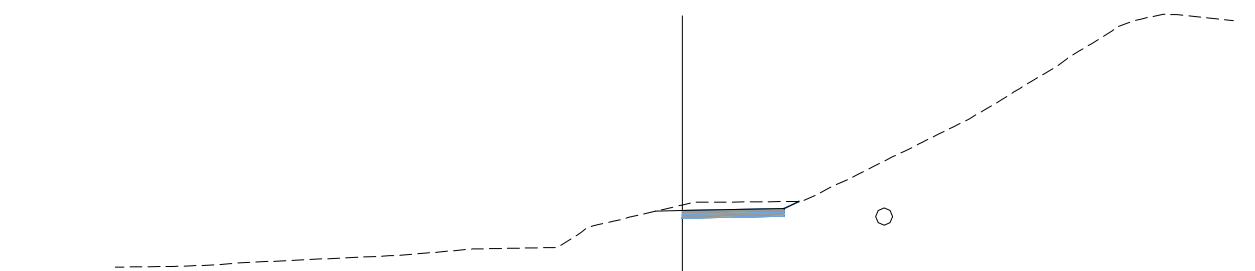

HAD = 279.00m					
- CUT +FILL			-0.15		
DESIGN LEVEL		281.78			
EXISTING LEVEL	280.28	281.93	282.02	282.02	
OFFSET	-15.00	0.00	2.70	3.08	15.00

70.00

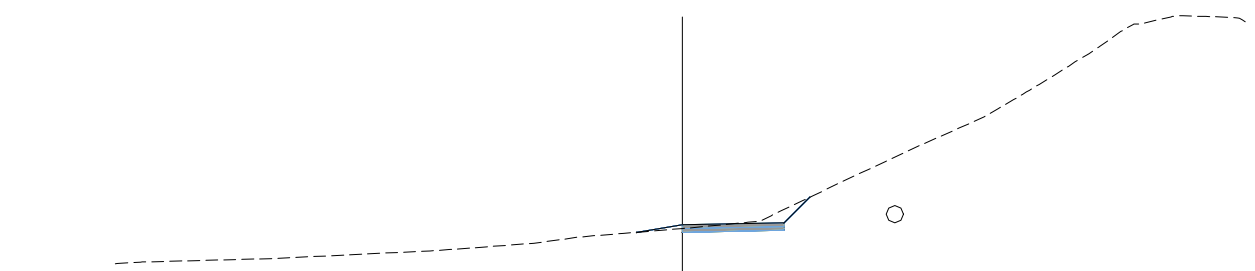

HAD = 279.00m					
- CUT +FILL			0.00	0.10	
DESIGN LEVEL		281.09	281.29		
EXISTING LEVEL	280.26	281.09	281.19	281.34	282.02
OFFSET	-15.00	-1.20	0.00	2.70	3.38

60.00

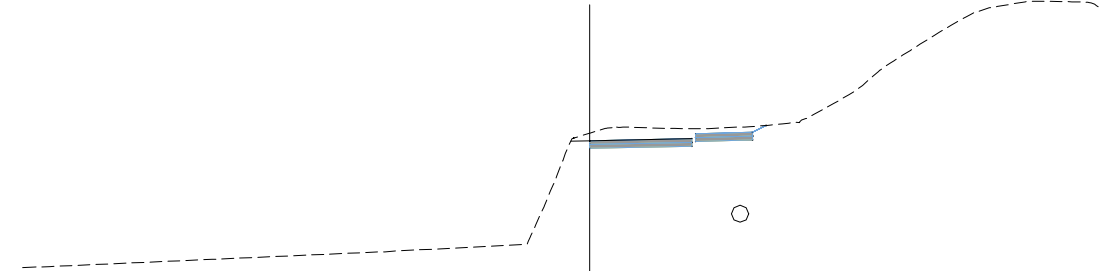

HAD = 279.00m					
- CUT +FILL			-0.20		
DESIGN LEVEL		283.74			
EXISTING LEVEL	280.38	283.94	284.05	283.79	
OFFSET	-15.00	0.00	2.70		15.00

110.00

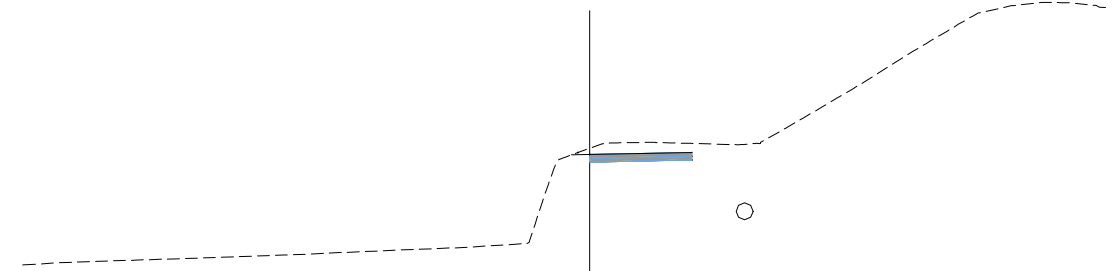

HAD = 279.00m					
- CUT +FILL			-0.17		
DESIGN LEVEL		283.26			
EXISTING LEVEL	280.34	283.43	283.55	283.31	
OFFSET	-15.00	0.00	2.70		15.00

100.00

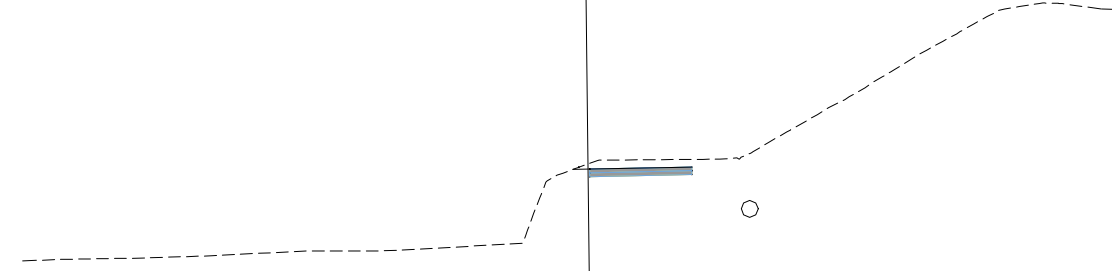

HAD = 279.00m					
- CUT +FILL			-0.15		
DESIGN LEVEL		282.76			
EXISTING LEVEL	280.34	282.91	283.02	282.82	
OFFSET	-14.96	0.00	2.70		15.00

90.00

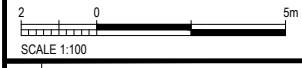

SCALE 1:100

0	FOR TENDER	PJC	LG	LL	04.24
A	FOR CLIENT REVIEW	KW	EG		02.24
REV		DRN	CHK	APP	DATE

SURVEYED		
DESIGNED	Edward Guerreiro	05/23
DRAWN	Kerry Ware	02/2024
CAD REVIEW	Phillip Cook	03.04.24
DESIGN CHECK	Lachlan Goldsworthy	05.04.24
DESIGN REVIEW	Derek Chinn	05.04.24
APPROVED	Leslie Lyall	05.04.24
PROF REGISTRATION:		



Client
WANAKA LAKEFRONT DEVELOPMENT PROJECT - STAGE 5
WANAKA MARINA AND YACHT CLUB
 PATH CROSS-SECTIONS
 SHEET 2 OF 4

NOT FOR CONSTRUCTION

Status Stamp	FOR TENDER
Date Stamp	05.04.24
Scales	AS SHOWN
Drawing No.	310103860-05-001-C302
Rev.	0

DO NOT SCALE - IF IN DOUBT, ASK

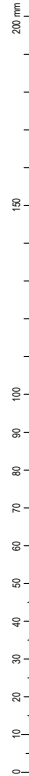

ORIGINAL SIZE A1

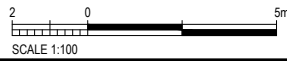
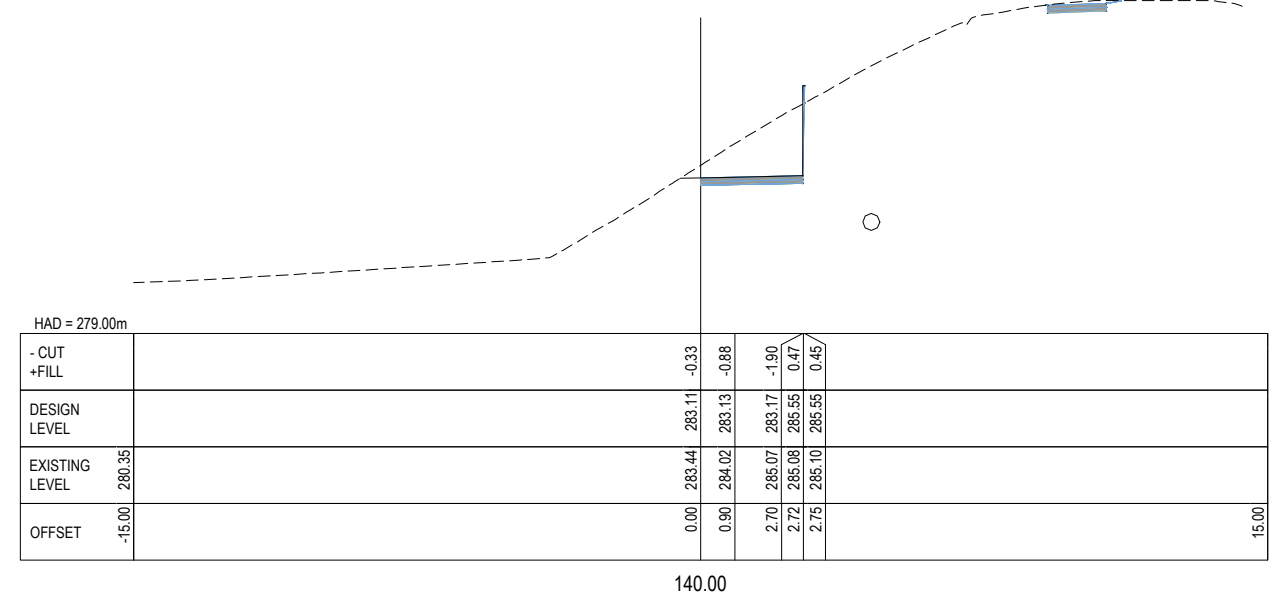
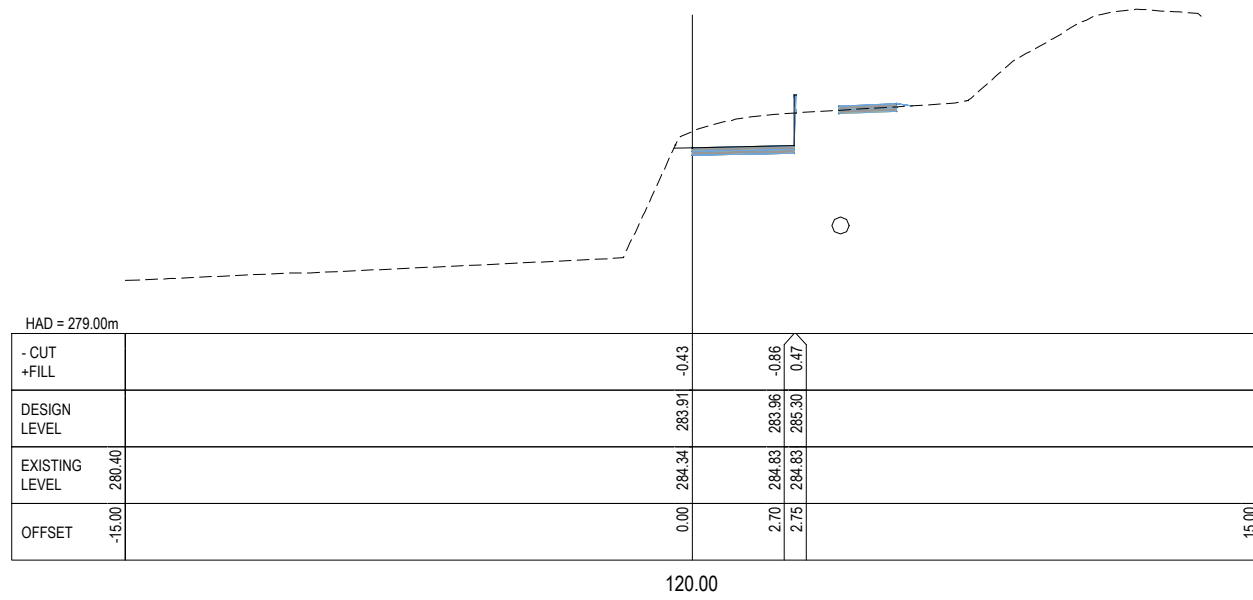
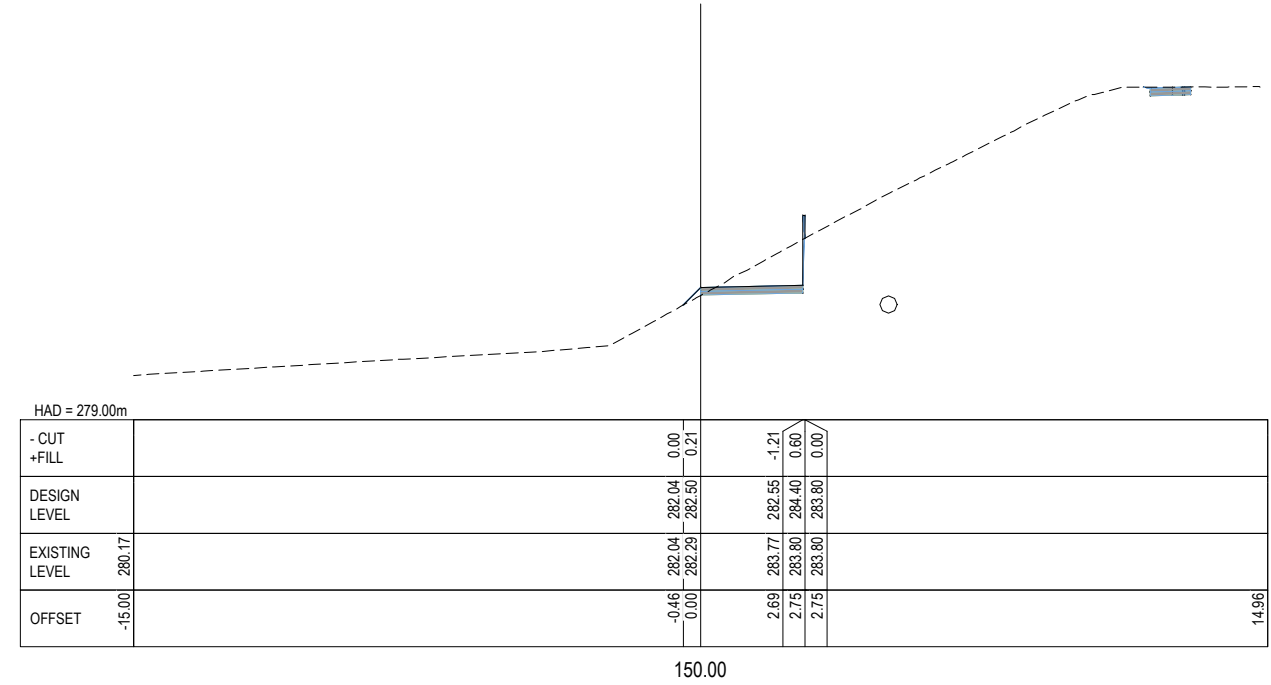
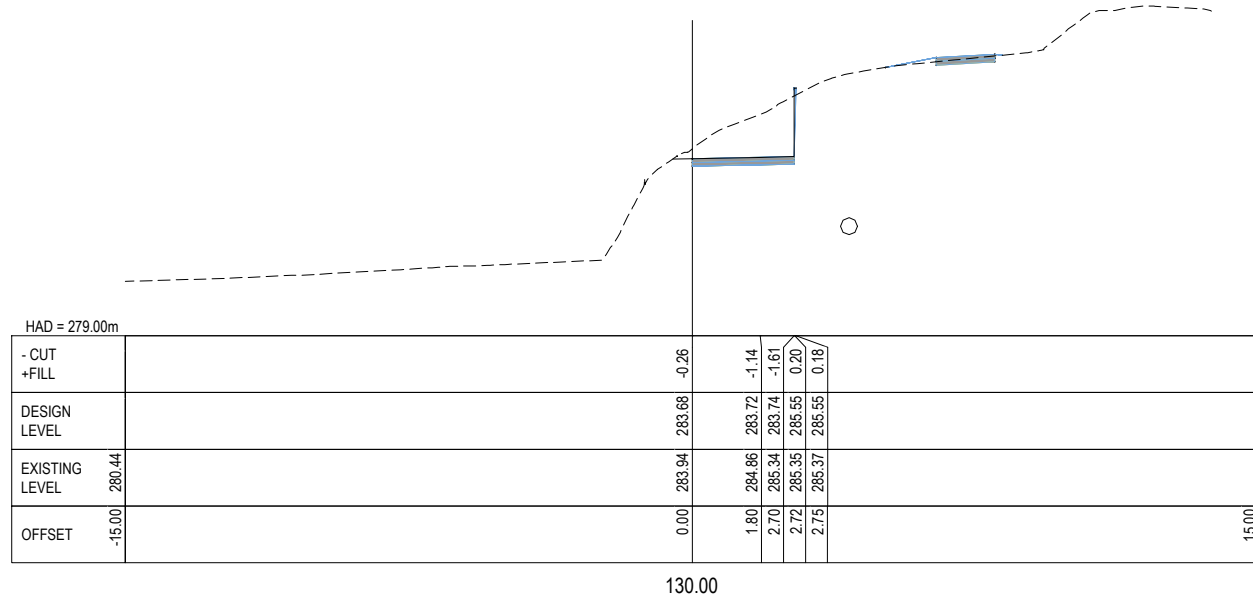

SCALE 1:100

REV	DESCRIPTION	PJC	LG	LL	DATE
0	FOR TENDER				04.24
A	FOR CLIENT REVIEW	KW	EG		02.24
		DRN	CHK	APP	DATE

PROF REGISTRATION:	DATE
SURVEYED	05/23
DESIGNED	05/23
DRAWN	02/2024
CAD REVIEW	03.04.24
DESIGN CHECK	05.04.24
DESIGN REVIEW	05.04.24
APPROVED	05.04.24



Client
WANAKA LAKEFRONT DEVELOPMENT PROJECT - STAGE 5
WANAKA MARINA AND YACHT CLUB
 PATH CROSS-SECTIONS
 SHEET 3 OF 4

Status Stamp	NOT FOR CONSTRUCTION
	FOR TENDER
Date Stamp	05.04.24
Scales	AS SHOWN
Drawing No.	310103860-05-001-C303
Rev.	0

DO NOT SCALE - IF IN DOUBT, ASK

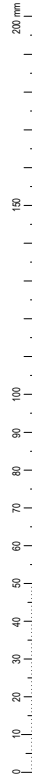

ORIGINAL SIZE A1

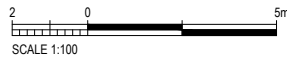
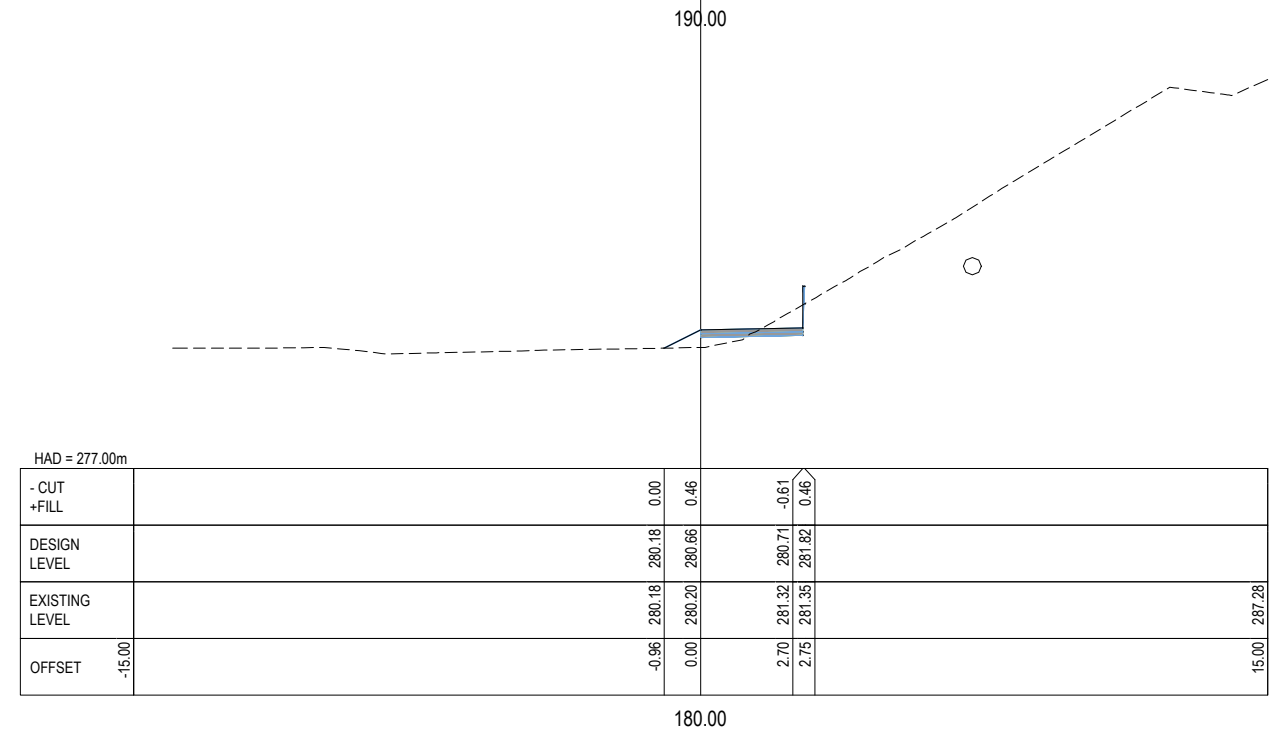
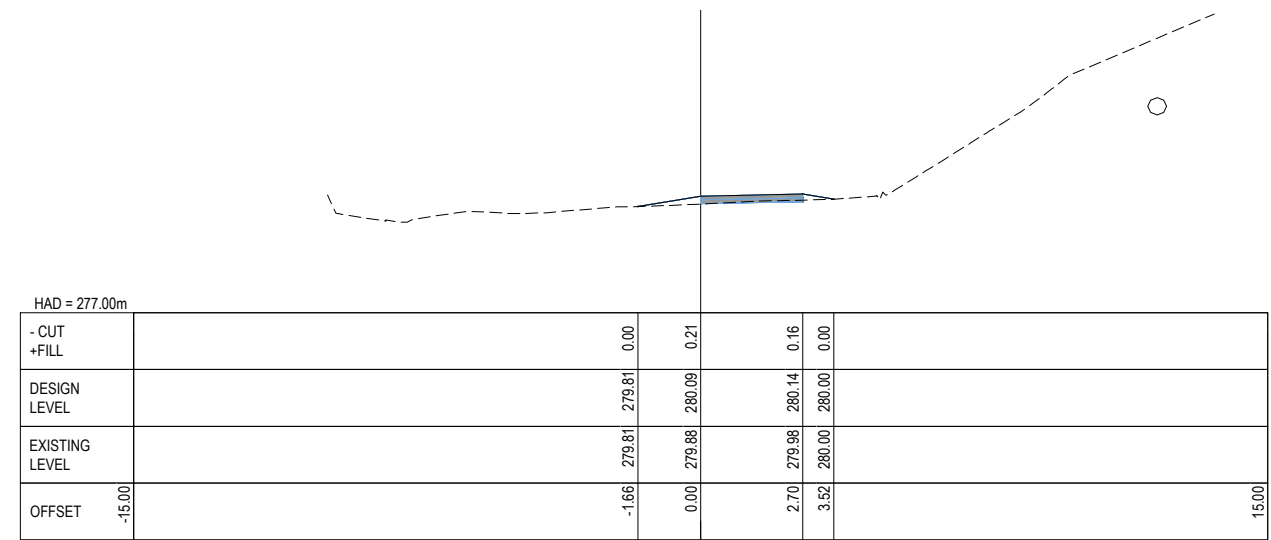
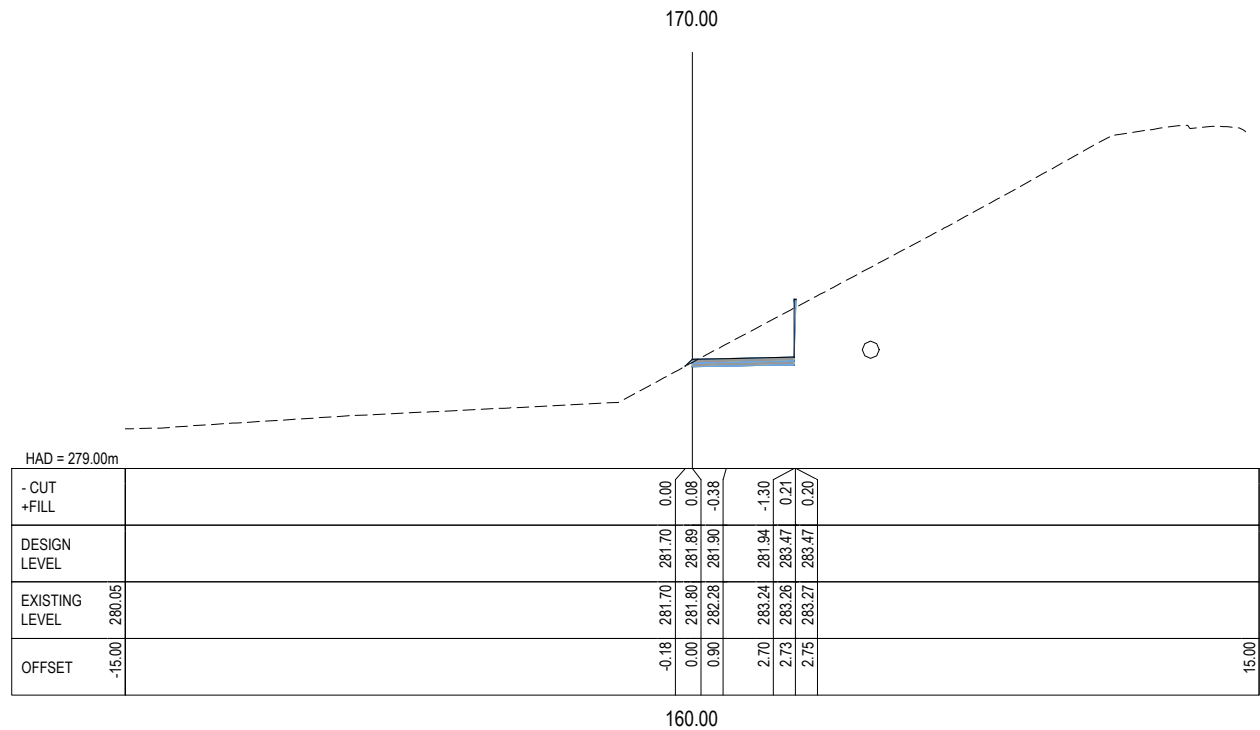
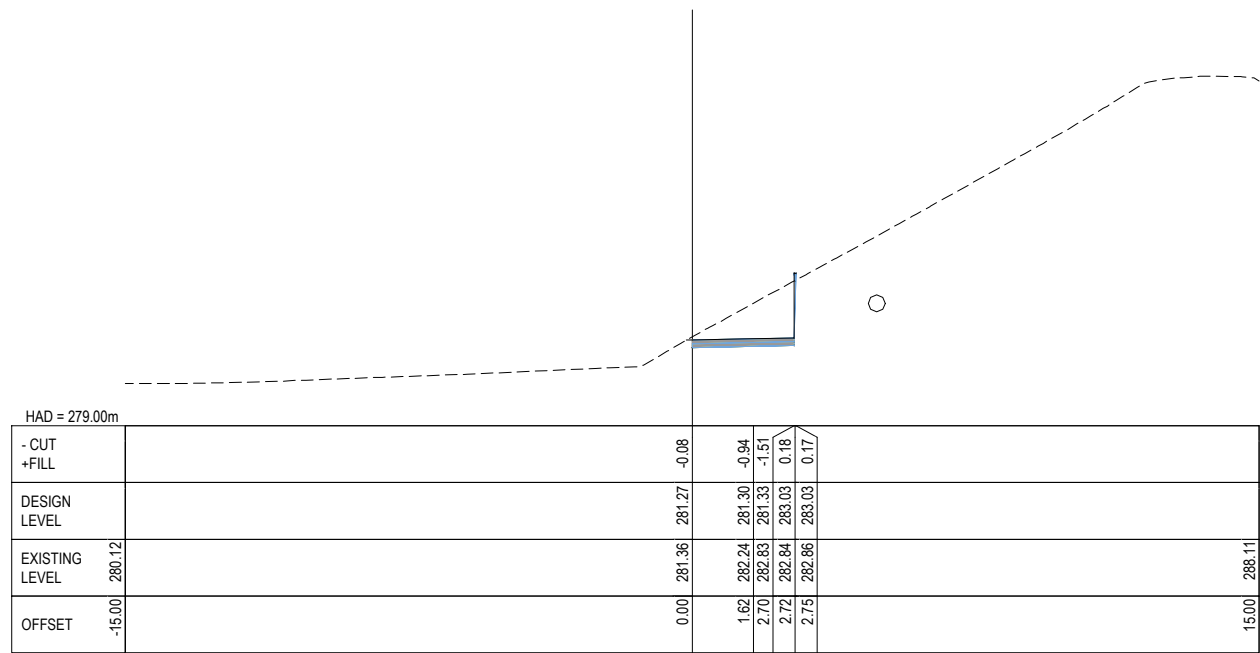

REV	DESCRIPTION	PJC	LG	LL	DATE
0	FOR TENDER				04.24
A	FOR CLIENT REVIEW	KW	EG		02.24
		DRN	CHK	APP	

ACTIVITY	BY	DATE
SURVEYED		
DESIGNED	Edward Guerreiro	05/23
DRAWN	Kerry Ware	02/2024
CAD REVIEW	Phillip Cook	03.04.24
DESIGN CHECK	Lachlan Goldsworthy	05.04.24
DESIGN REVIEW	Derek Chinn	05.04.24
APPROVED	Leslie Lyall	05.04.24



Client: WANAKA LAKEFRONT DEVELOPMENT PROJECT - STAGE 5
 WANAKA MARINA AND YACHT CLUB

PATH CROSS-SECTIONS
 SHEET 4 OF 4

NOT FOR CONSTRUCTION

Status Stamp	FOR TENDER
Date Stamp	05.04.24
Scales	AS SHOWN
Drawing No.	310103860-05-001-C304
Rev.	0

DO NOT SCALE - IF IN DOUBT, ASK

200 mm
150
100
90
80
70
60
50
40
30
20
10
0

ORIGINAL SIZE A1

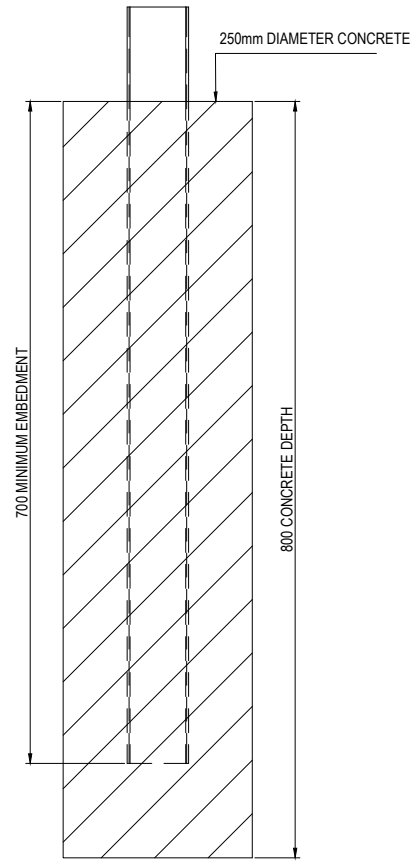
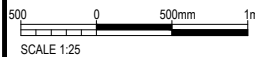

IN GROUND POST CONNECTION

BALUSTRADE DETAILS - ex URBAN GROUP
NOT TO SCALE

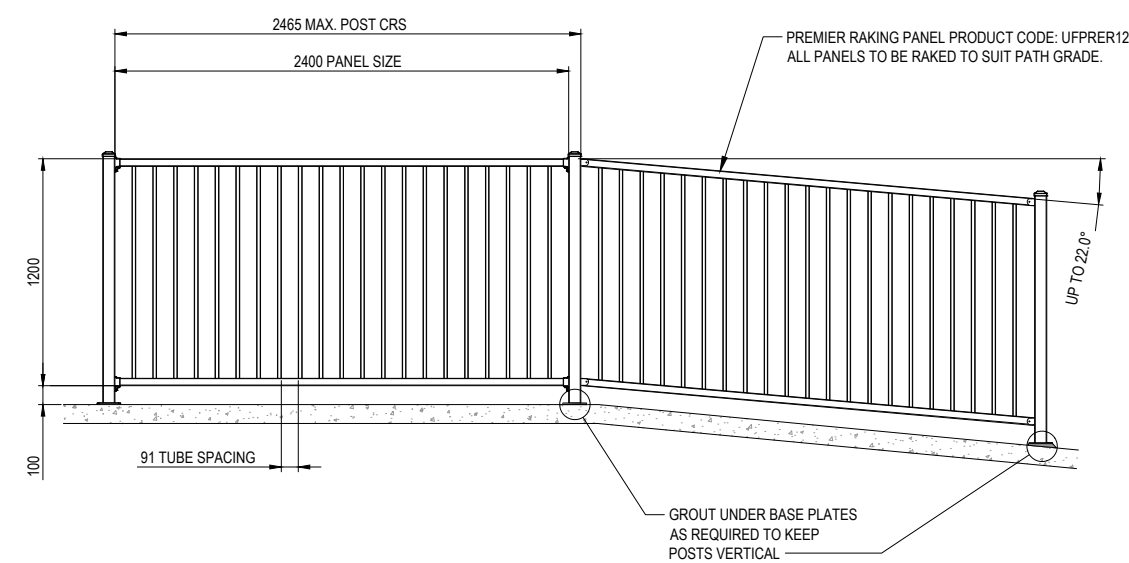

BALUSTRADE DETAILS - ex URBAN GROUP
NOT TO SCALE

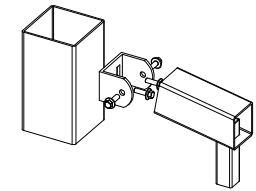

RAKING PANEL TO POST DETAIL

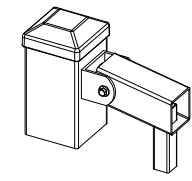

RAKING PANEL TO POST DETAIL

REFER TO MANUFACTURERS
DETAILS FOR INSTALLATION

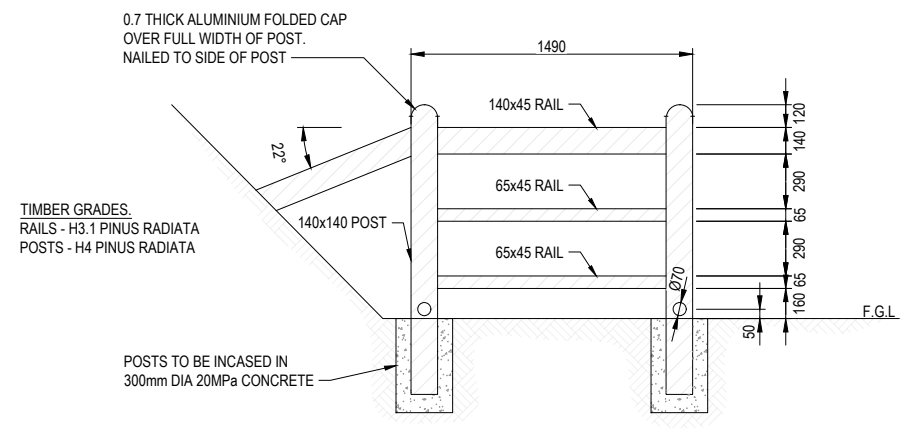

TRAIL DESIGN STANDARD TYPE A
SCALE 1 : 20

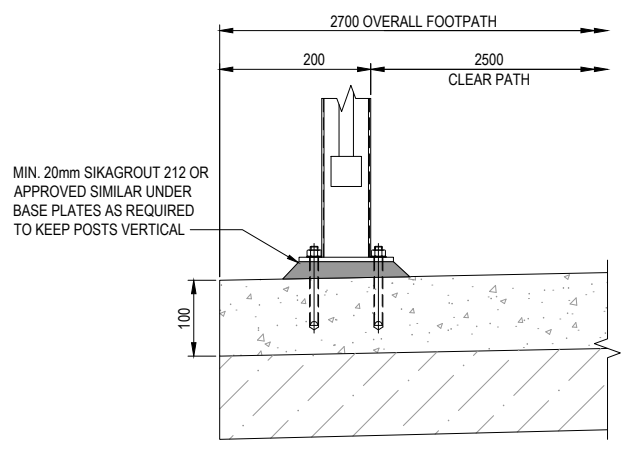

DETAIL 8
SCALE 1 : 10
C804
BALUSTRADE FIXING DETAIL

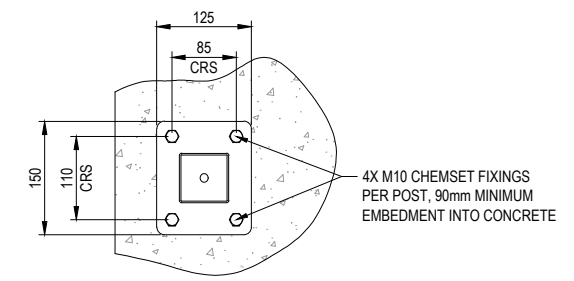

BASEPLATED POST CONNECTION
SCALE 1 : 5

REV	DESCRIPTION	DATE	APP	CHK	DRN
0	FOR TENDER	04/24	PJC	LG	LL
B	FOR REVIEW	03/24	KW	EG	
A	FOR CLIENT REVIEW	08/23	PJC	EG	
	REVISIONS		DRN	CHK	APP

STATUS	NAME	DATE
SURVEYED		
DESIGNED	Edward Guerreiro	05/23
DRAWN	Phillip J Cook	11/23
CAD REVIEW	Phillip Cook	04.04.24
DESIGN CHECK	Lachlan Goldsworthy	05.04.24
DESIGN REVIEW	Derek Chinn	05.04.24
APPROVED	Leslie Lyall	05.04.24
PROF REGISTRATION:		



WANAKA LAKEFRONT DEVELOPMENT PROJECT - STAGE 5
WANAKA MARINA AND YACHT CLUB

TYPICAL DETAILS
SHEET 1 OF 4

NOT FOR CONSTRUCTION

Status Stamp	FOR TENDER
Date Stamp	05.04.24
Scales	AS SHOWN
Drawing No.	310103860-05-001-C801
Rev.	0

DO NOT SCALE - IF IN DOUBT, ASK

ORIGINAL SIZE A1

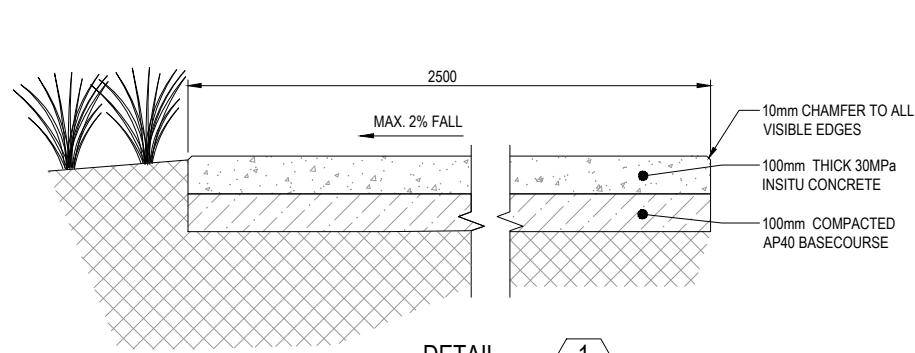

DETAIL 1
SCALE 1 : 10

STANDARD CONCRETE PATH SECTION

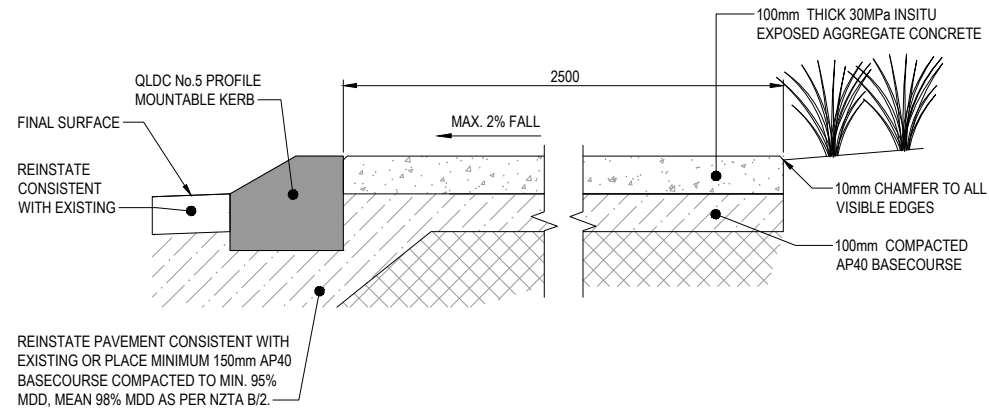

DETAIL 2
SCALE 1 : 10

CONCRETE SHARED PATH SECTION

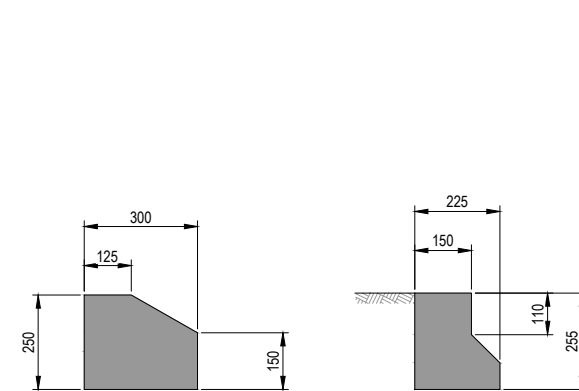

QLDC No.5 MOUNTABLE KERB

QLDC No.3 NIB KERB

DETAIL 3
SCALE 1 : 10
QLDC KERB PROFILES

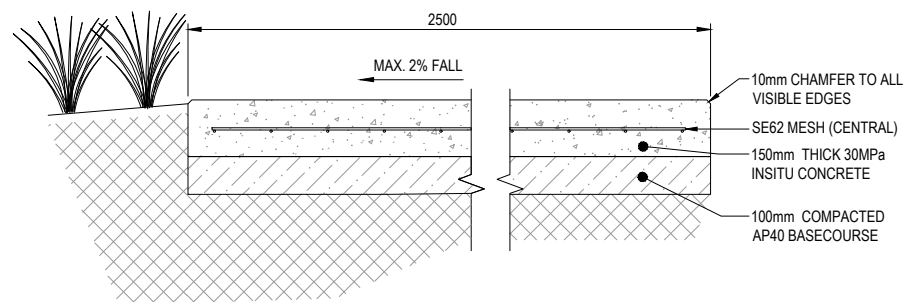

DETAIL 1A
SCALE 1 : 10

REINFORCED CONCRETE PATH SECTION

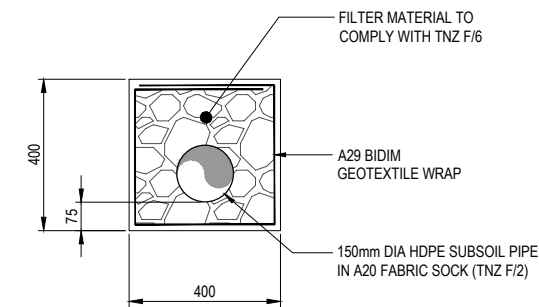

DETAIL 5
SCALE 1 : 10

TYPICAL SUBSOIL DRAIN

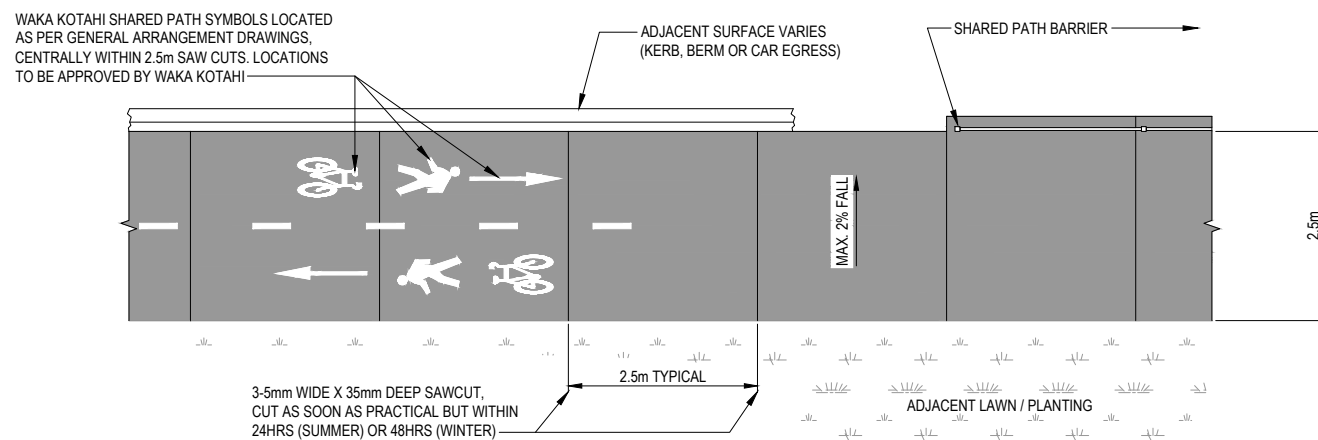

DETAIL 4
SCALE 1 : 50

SHARED PATH SAWCUT LAYOUT



NOT FOR CONSTRUCTION

REV	DESCRIPTION	DATE	BY	CHECKED	APP
0	FOR TENDER	04.24	PJC	LG	LL
B	FOR CLIENT REVIEW	15.03.24	KW	EG	
A	FOR REVIEW	11/23	PJC		
	REVISIONS		DRN	CHK	APP

STATUS	DATE	BY
SURVEYED	05/23	Edward Guerreiro
DESIGNED	11/23	Phillip J Cook
CAD REVIEW	04.04.24	Phillip Cook
DESIGN CHECK	05.04.24	Lachlan Goldsworthy
DESIGN REVIEW	05.04.24	Derek Chinn
APPROVED	05.04.24	Leslie Lyall



WANAKA LAKEFRONT DEVELOPMENT PROJECT - STAGE 5
WANAKA MARINA AND YACHT CLUB

TYPICAL DETAILS
SHEET 2 OF 4

Status Stamp	FOR TENDER
Date Stamp	05.04.24
Scales	AS SHOWN
Drawing No.	310103860-05-001-C802
Rev.	0

DO NOT SCALE - IF IN DOUBT, ASK

ORIGINAL SIZE A1

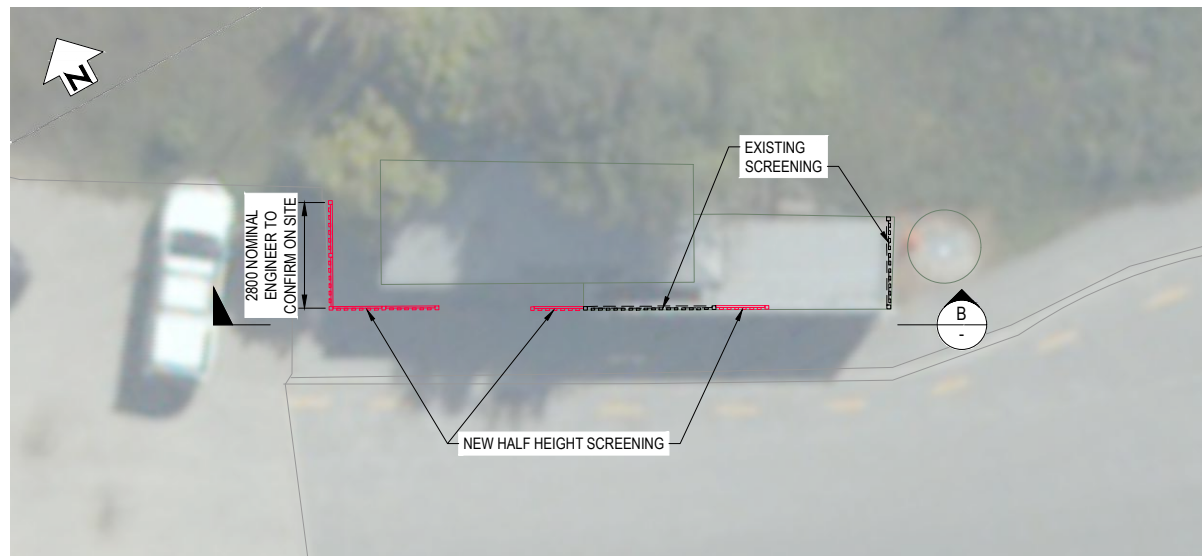

SITE PLAN
NOT TO SCALE

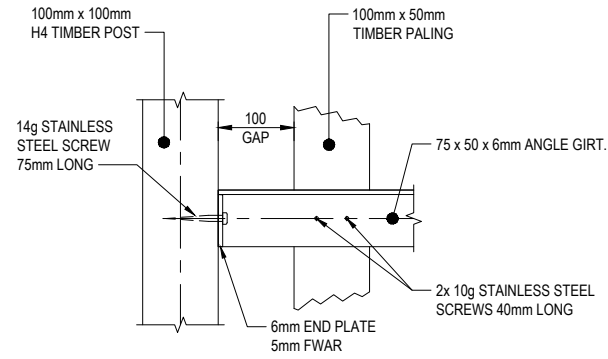

DETAIL 6
SCALE 1 : 5
NEW FENCE CONNECTION DETAILS

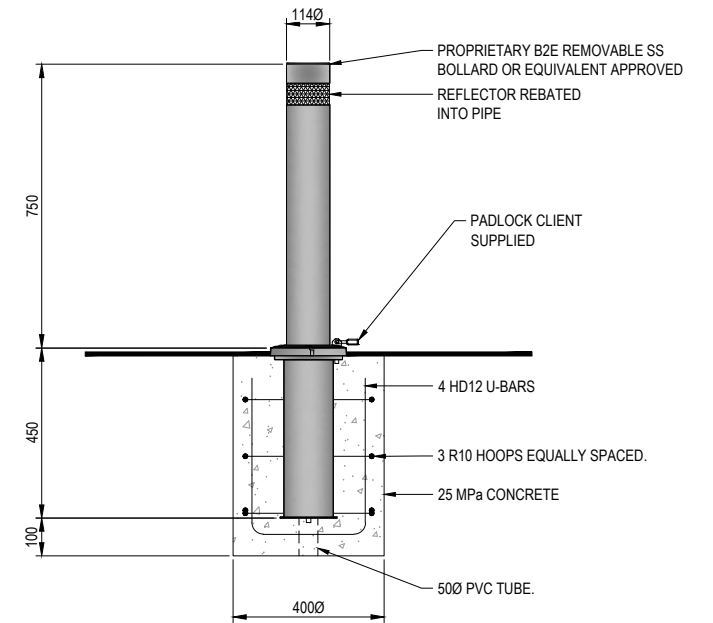

DETAIL 7
SCALE 1 : 10
TYPICAL REMOVABLE BOLLARD DETAIL

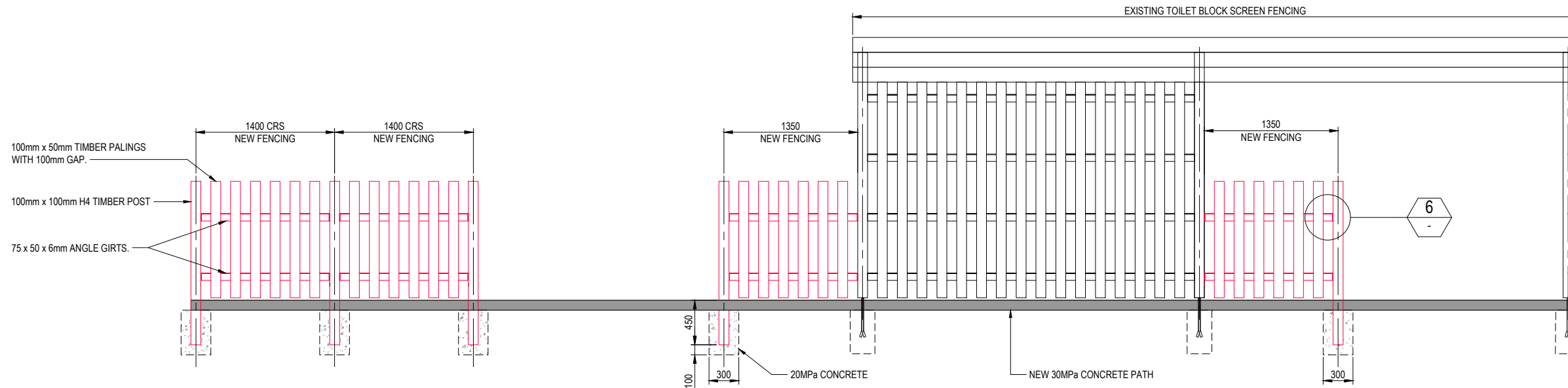

SECTION B
SCALE 1 : 25
NEW FENCE LAYOUT

NOTE
SEE DRAWING 310103860-05-001-C002 FOR ALL STRUCTURAL TIMBER AND STEEL NOTES.

200 0 500mm
SCALE 1:10

NOT FOR CONSTRUCTION

REV	DESCRIPTION	DATE	APP	CHK	DRN
0	FOR TENDER	04.24	PJC	LG	LL
B	FOR REVIEW	03.24	KW	EG	
A	FOR CLIENT REVIEW	14.02.24	KW	EG	
	REVISIONS		DRN	CHK	APP

SURVEYED		
DESIGNED	Edward Guerreiro	05/23
DRAWN	Phillip J Cook	08/23
CAD REVIEW	Phillip Cook	04.04.24
DESIGN CHECK	Lachlan Goldworthy	05.04.24
DESIGN REVIEW	Derek Chinn	05.04.24
APPROVED	Leslie Lyall	05.04.24
PROF REGISTRATION:		



WANAKA LAKEFRONT DEVELOPMENT PROJECT - STAGE 5
WANAKA MARINA AND YACHT CLUB

TYPICAL DETAILS
SHEET 3 OF 4

Status Stamp	FOR TENDER
Date Stamp	05.04.24
Scales	AS SHOWN
Drawing No.	310103860-05-001-C803
Rev.	0

DO NOT SCALE - IF IN DOUBT, ASK

ORIGINAL SIZE A1

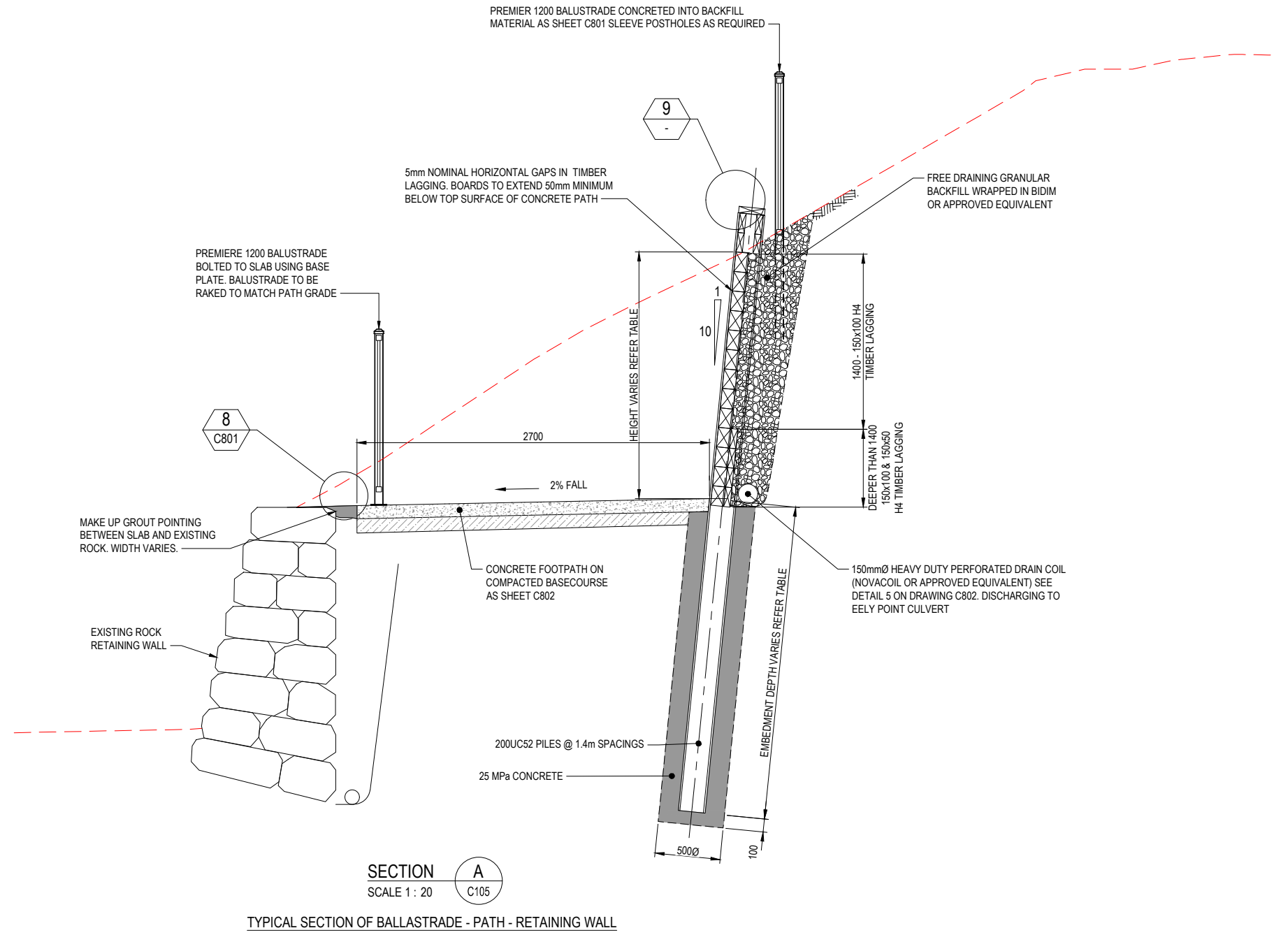
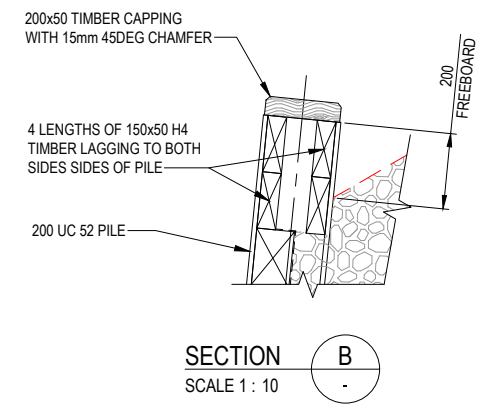
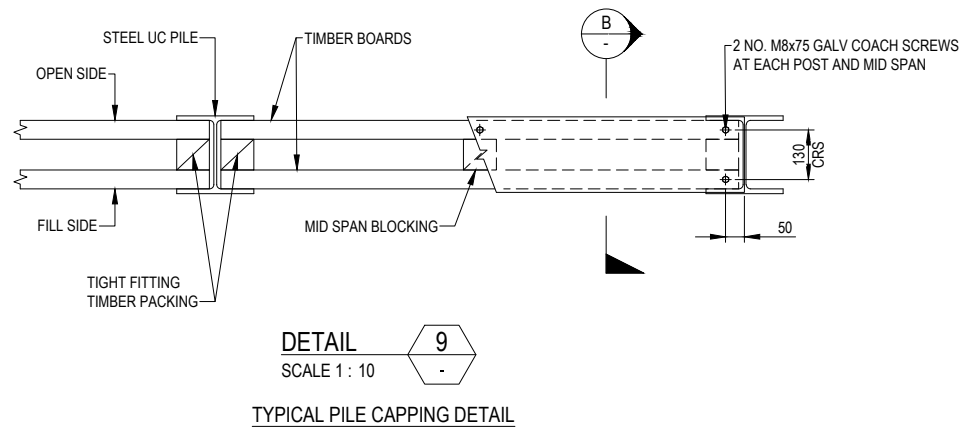
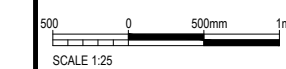

NOT FOR CONSTRUCTION

REV	DESCRIPTION	PJC	LG	LL	04.24
0	FOR TENDER				
A	FOR CLIENT REVIEW	KW	EG	IB	02.24
		DRN	CHK	APP	DATE

SURVEYED		
DESIGNED	Edward Guerreiro	05/23
DRAWN	Kerry Ware	03/24
CAD REVIEW	Phillip Cook	04.04.24
DESIGN CHECK	Lachlan Goldsworthy	05.04.24
DESIGN REVIEW	Derek Chinn	05.04.24
APPROVED	Leslie Lyall	05.04.24
PROF REGISTRATION:		



Client
WANAKA LAKEFRONT DEVELOPMENT PROJECT - STAGE 5
WANAKA MARINA AND YACHT CLUB

TYPICAL DETAILS
 SHEET 4 OF 4

Status Stamp	FOR TENDER
Date Stamp	05.04.24
Scales	AS SHOWN
Drawing No.	310103860-05-001-C804
Rev.	0